

UNITED STATES DEPARTMENT OF AGRICULTURE
FOREST SERVICE
NORTH PACIFIC DISTRICT

ADDRESS REPLY TO
DISTRICT FORESTER
AND REFER TO

Post Office Building
Portland, Oreg.

S R-6
Timber Surveys, Malheur
Mid. Fk. John Day River Project¹

December 14, 1931

The Forester,
Washington, D. C.

Dear Sir:

Your letter of December 9 and enclosures are received.

One copy of the corrected cost report pertaining to this project is enclosed for your information.

Very truly yours,

C. J. Buck, Regional Forester
By *Howard Hopkins* Acting

Enclosures

¹ This document was transcribed from a photocopy of the original, which is located in the Supervisor's Office Silviculture Library Archives. To the greatest extent possible, this version is an exact duplicate of the original text.

S.
Timber Surveys, R-6, Malheur
Mid. Fork. John Day

December 9, 1931

Regional Forester,
Portland, Oreg.

Dear Sir:

Your letter of December 1 is received.

In accordance with your request we are returning the Cost Report sent the Forester with your letter of November 18 for necessary corrections.

Very truly yours,

Howard Hopkins.

Howard Hopkins,
Acting Assistant Forester.

Enclosure.

UNITED STATES DEPARTMENT OF AGRICULTURE
FOREST SERVICE
NORTH PACIFIC DISTRICT

ADDRESS REPLY TO
DISTRICT FORESTER
AND REFER TO

Post Office Building
PORTLAND, Oreg.

S R-6
Timber Surveys, Malheur
Mid. Fork John Day

December 1, 1931

The Forester,
Washington, D. C.

Dear Sir:

Reference is made to my letter of November 18.

Because of an error in transcription of the figures pertaining to the timber volume, it is found necessary to rewrite the first and last pages of the Cost Report for this project. Please return the copy sent to you at your earliest convenience. When the necessary corrections have been made, it will be returned to you.

Very truly yours,

C. J. Buck

C. J. Buck,
Regional Forester

UNITED STATES DEPARTMENT OF AGRICULTURE
FOREST SERVICE
NORTH PACIFIC DISTRICT

ADDRESS REPLY TO
DISTRICT FORESTER
AND REFER TO

POST OFFICE BUILDING
PORTLAND, OREGON

S R-6
Timber Surveys, Malheur
Mid. Fork John Day River Project

December 11, 1931

The Forester,
Washington, D. C.

Dear Sir:

One copy of the descriptive report pertaining to this project is enclosed for your information.

Very truly yours,
C. J. BUCK, Regional Forester
By *D. Mavauagh* Acting

Enclosure

UNITED STATES DEPARTMENT OF AGRICULTURE
FOREST SERVICE
NORTH PACIFIC DISTRICT

ADDRESS REPLY TO
DISTRICT FORESTER
AND REFER TO

POST OFFICE BUILDING
PORTLAND, OREGON

S R-6
Timber Surveys, Malheur
Mid. F. John Day River Project

November 18, 1931

The Forester,
Washington, D. C.

Dear Sir:

There is enclosed for your information one copy of the Cost Report pertaining to this project.

The Descriptive Report is now awaiting the Supervisor's approval and I hope to mail you a copy of it within a short time.

Very truly yours,

C. J. Buck

C. J. BUCK
Regional Forester

Enclosure

C O S T R E P O R T

I. Acreage and Mileage

1. Total gross area mapped	32,154 acres
2. Net acreage national forest land	
Cruised 10% basis	26,954 acres
Cruised 5% basis	<u>2,720</u> acres
	Total 29,674 acres
3. Number of miles of level lines with transit and stadia.	37.5 miles
4. Number of miles of control ones with compass, chain and abney or altimeter	53.0 miles
5. Mileage of strip control lines single run, 5% cruise 17 miles double run, 10% cruise 338.7 miles	Total 355.7 miles
6. Saw timber volume of National Forest timber cruised 190.738 M. ft. BM	

II. Field Expenses

1. Cost of subsistence supplies	\$349.33
2. Cost of cook's wages	115.00
3. Cost of packing, hauling, etc.	175.07
4. Travel expenses	95.24
5. Equipment and auto expenses	<u>10.55</u>
6. Total all field expenses	\$ 745.19
7. Average daily expenses per man \$1.34 (Based on 556 man-days in field)	

III. Field Work

1. Total expenditures for salaries	\$1,841.73
2. Average size of crew exclusive of cook and packer	11.4 men
3. Average individual monthly salary	\$100.00
4. Transit control lines (Man days - 67	
(Salary	\$169.22
(Expense (pro rated)	<u>89.80</u>
Cost	\$259.02

5. Compass control lines	(Man days - 100 (Salary (Expense (pro rated) Cost	\$276.02 <u>134.03</u>	\$410.05
6. Strip cruising	(Man days - 212 (Salary (Expense (pro rated) Cost	\$651.78 <u>284.14</u>	\$935.92
7. Camp computing and compilations	(Man days - 18 (Salary (Expense (pro rated) Cost	\$96.69 <u>24.12</u>	\$120.81
8. Supervision	(Man days - 14 (Salary (Expense (pro rated) Cost	\$120.10 <u>18.76</u>	\$138.86
9. Travel; moving, establishing camps and camp chores	(Man days - 63 (Salary (Expense (pro rated) Cost	\$249.60 <u>84.44</u>	\$334.04
10. Sundays; rain; leave, and holidays	(Man days - 82 (Salary (Expense (pro rated) Cost	\$278.32 <u>109.90</u>	\$388.22
11. Total cost of field work	(Man days - 556 (Salary (Expense (pro rated) Cost	\$1,841.75 <u>745.19</u>	\$2,586.92
12. per acre cost of field work -- Based on gross acreage Based on N. F. acreage			\$.0801 per acre .0867 per acre

IV. Headquarters Office Work

1. Computations	(Man days - 110 (Salary (Expense Cost	\$613.89 <u>--</u>	\$613.89
2. Map making, drafting, and printing	(Man days - 75½ (Salary (Expense Cost	\$551.39 <u>28.37</u>	\$579.76

3. Type map	(Man days – 29 (Salary (Expense	\$193.06 <u>.94</u>	
	Cost		\$194.00
4. Written reports	(Man days – 13 (Salary (Expense	\$129.17 <u>.83</u>	
	Cost		\$130.00
5. Total cost of headquarters work	(Man days – 227½ (Salary (Expense	\$1,487.51 <u>30.14</u>	
	Cost		\$1,517.65
6. Per acre cost of headquarters office work --			
Based on gross acreage			\$.0469 per acre
Based on N. F. acreage			.0509 per acre

V. Summarized Cost of Project

1. Totals, field and headquarters office	(Man days – 783½ (Salary (Expense	\$3,329.24 <u>775.33</u>	
	Cost		\$4,104.57
2. Cost per acre for gross area mapped			\$.127
3. Cost per acre of national forest area mapped	(Field work (Headquarters (office work	\$.0867 <u>.0509</u>	
	Cost		\$.1376
4. Cost per M feet b.m., cruised by all methods			\$.0215

Fred A. Matz.

Fred A. Matz
Chief of Timber Surveys

S R-6
Timber Surveys, Malheur
Middle Fork John Day River Project

Portland, Oregon
June 1, 1931

DESCRIPTIVE REPORT

MIDDLE FORK JOHN DAY RIVER TIMBER SURVEY PROJECT

MALHEUR NATIONAL FOREST

1930

Fred A. Matz
Chief of Timber Surveys.

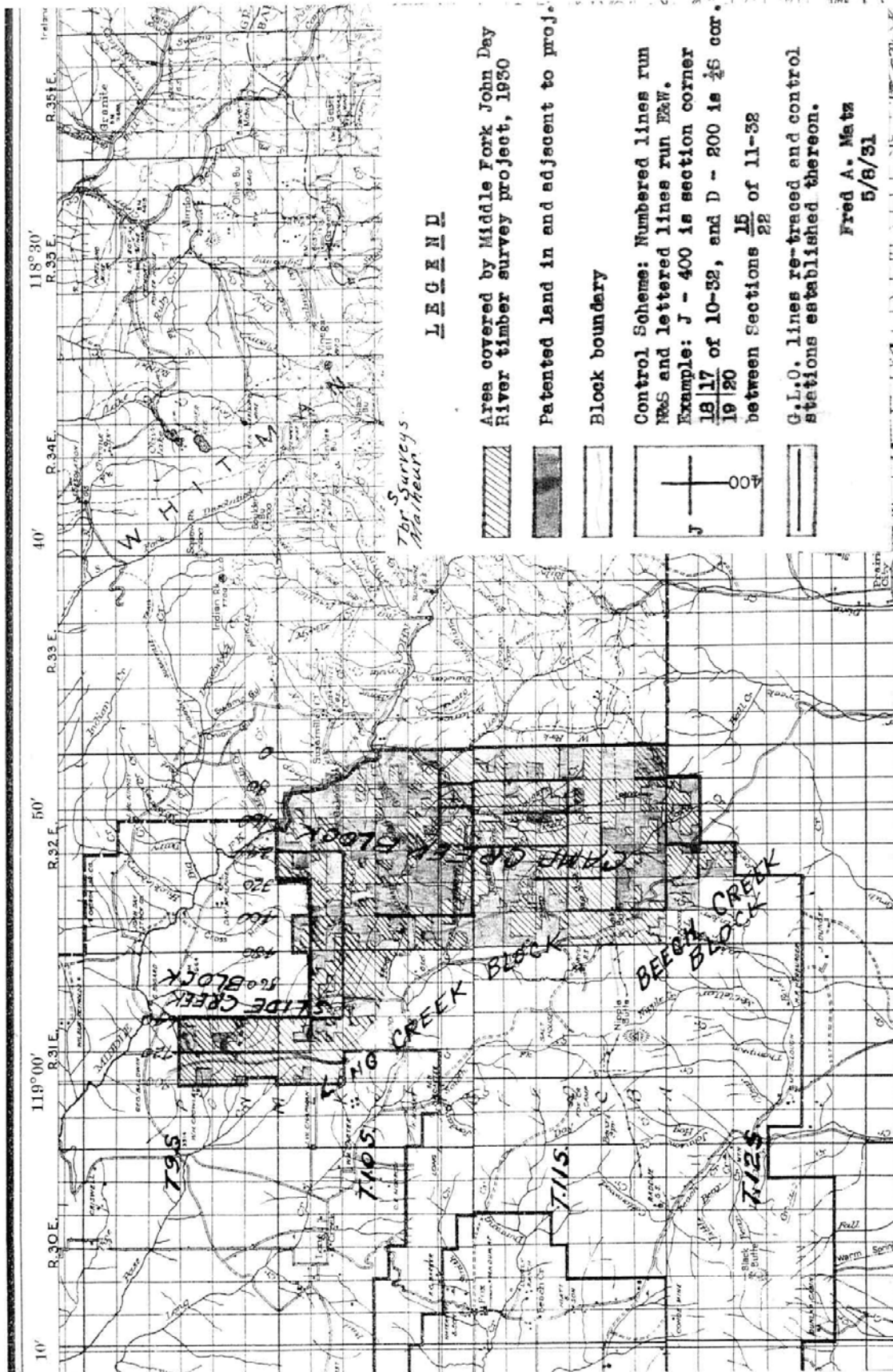

TABLE OF CONTENTS

	<u>Page No.</u>
Project Map	Frontispiece
I. INTRODUCTION	12
Maps.....	12
History of Project.....	12
Personnel	13
Location and Area	14
Unit Divisions.....	15
Status and Ownership	16
II. FIELD WORK AND COMPUTATIONS	17
Control Methods	17
Cruising Methods	17
Check Cruises	18
Office Computations.....	19
Volume Tables Used	20
Defect and Breakage Factors.....	20
III. SILVICULTURAL DESCRIPTION.....	21
Forest Types	21
Yellow Pine Type.....	21
White Fir-Larch-Douglas Fir Type.....	23
Lodgepole Pine Type.....	24
Non-timbered Types	24
Site Classification	24
Description of Timber	25
Western Yellow Pine.....	25
White Fir	25
Douglas fir.....	25
Reproduction	25
Silvicultural Management	25
Injurious Factors	26
Mistletoe	26
Beetles.....	26
Growth and Yield Data	26
IV. LOGGING DATA	26
V. STATISTICAL SUMMARY	27
Acreage of Forest Types	27
Timber Estimate	27
Poles	27
Project Timber Summary.....	27
VI. CONCLUSION.....	29

Portland, Oregon,
June 1, 1931.

DESCRIPTIVE REPORT

I. INTRODUCTION

Maps

A map on the scale of ¼-inch-equals-one-mile forms the frontispiece of this report. On it is shown the area covered in the project, the block divisions and other data corresponding with the accompanying legend.

Blue-line prints of the timber estimate plat and also of the topographic plat of each township involved in the project have been prepared and are bound in the timber survey folder in the office of Forest Management and copies sent to the supervisor. These plats are drawn on the scale of 4-inches-equals-one-mile, and are bound so that the estimate plat faces the topographic plat. On the timber estimate plats are shown the timber estimate by forties and a summary at the bottom that indicates the forest type acreages and timber estimate totals as they apply to the management units, the boundaries of which are shown with red ink. The topographic plats have been hand-colored in accordance with the standard legend to show the forest types and age classes.

History of Project

The Oregon Lumber Company owns most of the patented timber land in Camp Creek watershed and adjacent thereto. This company has been cutting private and Government timber at the headwater shed of the Middle Fork of John Day River for many years and it is understood are about cut out there. They have stated their desire to extend their logging railroad on down the River to tap their holdings on Camp Creek. These patented lands of theirs constitute about 50 per cent of the entire acreage in Camp Creek block, and since the intermingled Government timberland can be logged to best advantage at the time the company's land is logged, it was for the purpose of getting information for an appraisal of the stumpage value of the Government timber that the project was authorized.

Two camp sites were occupied by the crew. The first of these was on Slide Creek on the Tom Williams place about ¾ mile north of the Galena-Long Creek road. This camp was accessible to automobiles, and from there it was possible to drive short distances into the project. The second campsite was near the old dipping vats near the junction of Cougar Creek with Camp Creek. This camp site is not on a roadway and it was necessary to use pack animals for carrying equipment and supplies from the John O'Rorke place which is at the end of the road on Camp Creek and is about five miles below the camp site. Side camps were established at the George Armstrong place in Sec. 33 of 9 - 32 and at Hiyu Ranger Station. Supplies were purchased on contract from the Oregon Lumber Company's store at Bates.

Field work started on this project on September 11, the camp equipment having been moved from the Whitman side of the River to the John Day Stock Company's ranch with team and

wagon and from there to Slide Creek Camp with a ton truck furnished by the Malheur Forest. The same truck was used in moving the equipment from Slide Creek to John O'Rorke's place, from where the supplies were taken to Cougar Creek Camp. The move to Cougar Creek Camp was made on September 23, and the project completed from there on October 12. A side camp at Hiyu Ranger Station finished work on October 16.

While at Slide Creek Camp, most of the students had returned to their various schools and the party was reinforced by members left over from the Hoh River project on the Olympic Forest and by others hired especially to make up a full party.

Personnel

The party worked under the supervision of Fred A. Matz, chief of Timber Surveys. Frank Flack, of the Regional Office of Engineering, was assigned to the party to lay out the vertical control scheme. On September 20, Junior Forester Lester J. McPherson joined the party, his project on the Hoh River on the Olympic having been terminated. Junior Forester James Iler was transferred from the Mount Hood Forest to this party, arriving in camp on September 20. Clerk Wade Hall from the Wallowa National Forest joined the party on September 23 and remained until the project closed. D.H. Tripp of Union, Oregon, served in the capacity of camp cook in his usual highly satisfactory manner. His wages were at the rate of \$115.00 per month. Following is a list of the field assistants assigned to the party, the school with which they were affiliated, the period of service, position filled and the monthly wage. All of the field assistants were forestry school students, with the exception of Kenneth Dodge, who was hired locally, chiefly to assist in the establishment of control lines. Subsistence was furnished the men in addition to the wages stated.

1. Harold Boeger, Iowa State College, compassman, September 11 to October 2, at \$70. per month.
2. Robert Camp, Colorado College, estimator, September 11 to September 25 at \$70. per month.
3. Kenneth Dodge, no forestry training, control work, at \$70. per month.
4. Weston Donehower, University of Minnesota, estimator, September 11 to October 12, at \$70. per month.
5. H. C. Heine, Iowa State College, compassman, September 24 to October 12, at \$100. per month.
6. E. M. Howell, Iowa State College, estimator, September 19, to October 16, at \$90. per month.
7. H. A. Lucas, Oregon Agricultural College, compassman, September 11 to September 23, at \$80. per month.
8. W. B. Manlove, Oregon Agricultural College, compassman, September 11 to October 12, at \$100. per month.
9. M. M. Nelson, University of Washington, estimator, September 21 to October 16, at \$70. per month.
10. Lyall E. Peterson, University of Minnesota, estimator, September 11 to September 26, at \$70. per month.

11. F. B. Ramsay, Oregon Agricultural College, estimator, September 19 to October 12, at \$90. per month.
12. Arthur Rettman, Oregon Agricultural College, estimator, September 11 to September 22, at \$70. per month.
13. Milton R. Salls, Syracuse University, compassman, September 11 to October 12, at \$70. per month.
14. F. W. Schlegel, Oregon Agricultural College, compassman, September 11 to October 16, at \$100. per month.
15. Chas. M. Swanson, Iowa State College, compassman, September 11 to October 7, at \$70. per month.
16. Louis Tausch, Syracuse University, control work, September 1 to September 24, at \$70. per month.
17. Richard H. Tubman, Colorado College, compassman, September 11 to September 26, at \$ 70. per month.

The full number listed above was in camp only a few days just at the time some of the students were leaving to return to school and other men were being transferred to take their places.

Location and Area

Location

The greater portion of the timberland in the project is in Camp Creek watershed. Camp Creek flows into the Middle Fork John Day River about 20 miles northwest of Bates, Oregon. Galena, Oregon, which is, situated just across the river from the project area, is the nearest post office. There is also a small store and post office at Susanville, which is about two miles east of Galena. The nearest trading point and general merchandise store is at Bates, which is situated on the Sumpter Valley Railroad and also on a branch of the John Day Highway. A fair dirt road extends down the north bank of the river from Austin to a point about four miles below Galena. From there on down the river the road is very rough and rocky and almost impassable in the wet season. The Long Creek-Prairie City road passes along the summit of the divide between Camp Creek and Long Creek and touches along the south end of the project.

The Government acreage in all or portions of the following townships is included in the project: namely,

- T. 9 S., R. 31 E., W. M
- T. 10 S., R. 31 E., W. M.
- T. 10 S., R. 32 E., W. M.
- T. 11 S., R. 32 E., W. M
- T. 12 S., R. 32 E., W. M.

Area

The work was confined as much as possible to the National Forest lands, and as a result – patented lands were cruised and mapped only when in small isolated tracts so situated that it was necessary to cross them when running the strip surveys for the Government lands. The patented forties cruised are indicated on the township estimate plats by an encircled P, thus(P).

The total acreage covered is –

National Forest lands	29,674
Patented lands	<u>2,480</u>
Total	32,154

Unit Divisions

Four block subdivisions have been recognized in this project, namely, - Camp Creek, Slide Creek, Beech Creek and Long Creek. The boundaries of these blocks are shown on the small scale frontispiece map. Camp Creek Block and Slide Creek Block are both within the boundaries of the Middle Fork John Day River Working Circle, and it is believed the small acreage covered in each of the other two blocks named can well be logged to them. No compartment divisions have been, made for Long Creek Block and Beech Creek Block. Such divisions have been made in the other two blocks, but on account of their small size it has not been possible to show them on the frontispiece map.

The blocks are briefly described as follows:

Camp Creek Block:

This name is derived from the creek which drains the Block and which is a tributary of Middle Fork John Day River. The block has been divided into 20 compartments ranging in size from 284 acres to 2,168 acres of Government land. The more accessible timberland in the block is owned by the Oregon Lumber Co. and their holdings constitute about half the acreage of the entire block with the greater concentration in the northern portion so that the patented lands there in many of the compartments exceeds the acreage of the Government lands.

Camp Creek has an easy gradient and will afford a good route for a tap line railroad into the block. There is a sufficient width of flat land on one side or the other of the creek to permit of the location of the roadbed near the stream, and there are no unusually difficult problems to overcome. Other than in the narrow valley along the creek, there is very little level land in the block, and it is, as a whole, a rather rough logging chance, because of the steepness of the slopes and the numerous V-shaped valleys and ridges which break it up.

The acreage in this block is as follows:

Government	17,790 acres
Patented	<u>18,546 acres</u>
Total	36,336 acres

Slide Creek Block

This block joins the northwest portion of Camp Creek Block and it is quite likely that the southeastern portion of it, where there is the greatest concentration of patented lands, will be taken over the divide into Camp Creek. With the exception of the wide flat-ridge summits, the chances for easy logging are scarce. The greater portion of the block is situated on steep slopes draining into Slide Creek and the stand being rather light it is questionable as to whether or not a logging railroad is justifiable for the removal of the timber. It would seem, therefore, that the most logical solution for the handling of the timber, excluding that part which will log to Camp Creek, is to truck to a small local mill which could be located on Slide Creek off the Forest.

This block has been divided into 8 compartments, the smallest containing 151 acres and the largest 1,432 acres of Government lands. The total acreage in this block is as follows:

Government land	6,770 acres
Patented land	<u>3,416 acres</u>
Total	10,186 acres

Beech Creek Block

This block is situated on the headwaters of Beech Creek and joins Camp Creek block on the summit of the divide between Middle Fork John Day River and John Day River drainage. The portion covered in this block was cruised for the express purpose of completing the townships involved and it quite likely that some of the timber on and near the summit will be logged into Camp Creek. The block has not been divided into compartments and the acreage involved is as follows:

Government land	1,010 acres
Patented land	<u>1,330 acres</u>
Total	2,340 acres

Long Creek Block

The portions covered in this block join Slide Creek and Camp Creek blocks on the west, along the summit of the Long Creek divide, and were covered purposely to complete the township plats. Some of the timberland in that portion of the block bordering on Camp Creek block will be logged to Camp Creek, but the remainder cannot be taken to Slide Creek. No compartment subdivisions have been made in this block and the acreage involved is as follows:

Government land	4,104 acres
Patented land	<u>2,072 acres</u>
Total	6,176 acres

Status and Ownership

The location of the alienated lands is shown on the township plats prepared in connection with this report, as well as on the small scale frontispiece map. The most of the patented lands is owned by the Oregon Lumber Company and it is the intention of this company to conduct future logging operations in this region.

With the exception of the telephone line along Camp Creek and thence up Lick Creek and another line into Hiyu R. S. across the head of Camp Creek there are no Government improvements on the project. Two stock driveways traverse the area and are used quite extensively in the movement of sheep and cattle across the Forest. No roads enter the tract, excepting the Long Creek-Prairie City road along the divide at the south end of the project.

The acreage of all patented lands, by sections, is shown under the tabulations, Acreages of Forests Types, which appear later in this report, and is summarized, as follows:

Block name	Government Lands Acres	Alienated Lands Acres	Total Acres
Camp Creek	17,790	18,546	36,336
Slide Creek	6,770	3,416	10,186
Beech Creek	1,010	1,330	2,340
Long Creek	<u>4,104</u>	<u>2,072</u>	<u>6,176</u>
Totals	29,674	25,364	55,038

Only 2,480 acres out of the total patented acreage were covered by the timber survey.

II. FIELD WORK AND COMPUTATIONS

Control Methods

All the lines for both horizontal and vertical control were established in accordance with the special instructions issued by the Office of Engineering. Base lines for control were established by retracing, with chain and compass, the G. L. O. survey lines and marking thereon stations for starting and checking points for the strip surveys. The lines retraced are indicated on the frontispiece map. Elevations of the stations along these lines were determined with Paulin altimeter readings, corrected for variations as determined by readings in camp.

Elevations were established along the driveway along Camp Creek and along the Long Creek-Prairie City road by means of transit and stadia, starting and checking points being U. S. G. S. bench marks. Suitable points were marked along the transit line to be used for setting and checking the altimeters which were carried along the section lines retraced, and in many instances these markers were used as checking points for the vertical control on the strip surveys.

Horizontal positions along the strip surveys were determined by pacing, using a Forest Service standard compass, mounted on staff, for alignment. Elevations along the lines of strip survey were determined with aneroid barometer after adjustments were made for any possible error determined at time of closing in on the control lines.

Cruising Methods

Whenever it was necessary to cross patented lands on the strip surveys it was customary to map and cruise them. However, the timber volume pertaining to these lands has not been carried into the tabulations in this report and it will be necessary to refer to the supervisor's files for this information. Section 36 of T. 11 S., R. 32 E. was cruised on the assumption that it was Government land, but it was later found to be in private ownership. The SW $\frac{1}{4}$ of SW $\frac{1}{4}$ Sec. 28, 9-31 was assumed to be patented land, but a check on the status records indicates that it is Government land. No cruise was made on this forty and its acreage is accounted for in the Summary of Forest Type Acreages as unclassified.

All the areas of merchantable western yellow pine were cruised on a 10 per cent basis, running two strips through each forty. In white fir-larch-Douglas fir type and non-commercially timbered areas the cruising was on a 5 per cent basis by taking one chain width strip through each forty.

The acreages of Government land covered by these degrees of intensiveness are as follows:

10% cruise, 27,394 acres
 5% cruise, 2,280 acres
 Total- 29,674 acres

Western yellow pine trees 12 inches and over d. b. h. were tallied by 2-inch diameter classes in log length heights, the tally being kept separate for mature and immature age classes. Species other than western yellow pine were tallied by 2-inch diameter sizes only.

Check Cruises

Because of the many changes in personnel that took place on this project, it was not possible to get a check cruise on all the estimators assigned to the job, but of those on whom check cruising was done, it is estimated that at least 3 per cent of the area covered by each was check cruised. The check cruising was purposely done in the better timbered forties and therefore applies to more than 3 per cent of the actual timber tallied by the estimator. Comparative results of these check cruises follow:

Original cruise by L. E. Peterson, check cruise by Fred A. Matz in

- (1) S½ NE¼, Sec.33, T. 9 S., R. 31 E., and
- (2) S½ of N½, Sec. 34, T. 9 S., R. 31 E.

Species	Original Cruise		Check Cruise		Difference
	No. of Trees	Ft. B. M.	No. of Trees	Ft. B. M.	
Y	42	37,870	20	30,380	
Y-1	32	3,870	40	10,670	Number of trees=+13
(1) D	30	11,900	29	8,750	Ft. B. M. = +1700
WF	16	2,670	15	2,950	Per cent = +3.1%
WL	<u>0</u>	<u>-</u>	<u>3</u>	<u>1,860</u>	
Totals	120	56,310	107	54,610	
Y	68	85,280	34	51,510	Number of trees = +4
(2) Y-1	69	12,010	99	28,870	Ft. B.M. = +17,920
D	<u>42</u>	<u>12,370</u>	<u>50</u>	<u>11,360</u>	Per cent = + 18.4%
Totals	179	109,660	183	91,740	

Original cruise by A. Rettman, check cruise by Fred A. Matz, in

- (1) NE¼ of SW¼; N½ of SE¼, Sec. 22, T. 9 S., R. 31 E
- (2) S ½ of S ½, Sec. 22, T. 9 S., R. 31 E.

Species	Original Cruise		Check Cruise		Difference
	No. of Trees	Ft. B. M.	No. of Trees	Ft. B. M.	
Y	80	115,880	60	95,760	
Y-1	53	14,210	75	27,610	Number of trees = -3
(1) D	27	8,680	22	8,650	Ft. B. M. = + 3,150
WF	1	70	3	490	Per cent = +2.2%
WL	<u>9</u>	<u>2,740</u>	<u>13</u>	<u>5,920</u>	
Totals	170	141,580	173	138,430	
Y	55	61,310	57	70,340	
Y-1	71	19,760	67	22,300	Number of trees = -3
(2) D	17	5,990	23	7,140	Ft. B. M. = - 12,670
WF	17	2,140	13	2,110	Per cent + - 12.2
WL	<u>3</u>	<u>1,980</u>	<u>6</u>	<u>1,960</u>	
Totals	163	91,180	166	103,850	

(C) Comparison of totals for all above check cruises:

Cruise	Number of Trees	Volume of all Species, Feet B. M.
Original	632	398,730
Check	<u>629</u>	<u>388,630</u>
Difference	+ 3	+10,100 – 2.6 %

A record of the check cruises on the other estimators who served on this project will be found in the Descriptive Reports for the Middle Fork John Day River project, Whitman N. F., or for Camas Creek project, Umatilla N.F.

Office Computations

With the exception of a small amount of computing done in the field for the check cruises and general supervision work, all the computations and compilations were made in the Regional Office. Some of these compilation tables appear at the back of this report and others on the township estimate plats.

The B. M. volume of western yellow pine sawtimber was computed separately for mature and immature age classes. The immature age class corresponds closely to the class of trees which are reserved in selective marking and therefore represents about what will be left after cutting.

The B. M. volume of all species other than western yellow pine was computed as of one age class.

A summary of the timber estimates by blocks appears in Tables No. 8 to No. 11, inclusive, at the back of this report.

Volume Tables Used

For mature western yellow pine sawtimber there was used the Forester's Table, Washington Office, 1930, arranged for log length height classes. The second growth western yellow pine table by Hanzlik, December 1928, was used for computing the immature sawtimber volume.

Douglas fir, western larch and white fir were compiled from tables used in the compilation of the John Day River Project, Malheur N. F. in 1927.

The B. M. volumes by d. b. h. classes and associated species are given in Table No. 1, which follows:

Table No. 1.
Volume Tables for Associated Species

D.B.H. Inches	Timber Volume, Feet B. M., by Species				
	LP	DF	WL	ES	WF
12	8	7	9	5	
14	15	10	13	10	
16	18	14	20	16	
18	23	20	28	24	
20	30	28	40	34	
22	40	36	52	46	
24	52	46	65	62	Use same table as for D. fir and commute for diameters 12"-26" inclusive only
26	66	60	81	86	
28		75	99	113	
30		90	119	141	
32		110	146	169	
34		130	164		
36		142	190		
38		173	214		
40		197	242		
42		220	267		
44		260	293		
46		300	318		
48			343		
50			368		
52			396		
54			426		
56			456		
58			486		
60			516		

Defect and Breakage Factors

No deduction for defect or breakage has been computed for the immature class of western yellow pine sawtimber. A flat deduction of 5% was made in the mature western yellow pine sawtimber to allow for both defect and breakage. In the associated species this deduction ranges from 5% to 25%, depending upon the condition of the timber and the topography and character of the ground surface.

III. SILVICULTURAL DESCRIPTION

Forest Types

Yellow Pine Type

In the mature age class of this type there are trees of all age classes and a selection method of cutting is recommended. As a whole, the stand is rather light, the trees being widely spaced and more or less grouped. Only small acreages of pure yellow pine stands occur on the project and it is customary to find Douglas fir and white fir quite generally distributed and occasionally some western larch.

The acreage covered by this type is variable for the several management units as will be seen in the tabulations of Forest Type Acreages at the back of this report. The percentage covered in each unit is briefly summarized as follows:

Block Name	Percentage of Acreage in Yellow Pine Type
Camp Creek	66%
Slide Creek	56%
Beech Creek	54%
Long Creek	28%
For the Project	59%

There is a slight variation in the proportion of the mature age class, but in Camp Creek Block and for the project as a whole it is about $\frac{3}{4}$ of the acreage in the type.

The average per acre stand of timber throughout the mature age class (150 years plus) and in the immature age class (80-150 years) was obtained by a selection of the timber estimate sheets applicable to the type and age classes in all parts of the project. The acreage represented by the estimate sheets selected is about 10 per cent of the entire acreage in each age class. The results of the computations for these sample acres are shown in the two tables that follow, namely:

TABLE NO. 2

Sample Acre Stand in Mature YP Type (Y-4)

D.B.H. Inches	Average Number of Trees per Acre, by Species						
	Mature	Immature	L.P.	D	W.F.	W.L.	Total
4-7	.048	6,981	.209	3.657	2.009	.324	13.228
8-11	.287	3,709	.070	1.778	1.094	.351	7.289
12	.302	1.359	.003	.713	.295	.197	2.869
14	.328	.982	.003	.459	.235	.115	2.122
16	.433	.859	.007	.392	.242	.097	2.030
18	.515	.747	.003	.709	.201	.082	2.257
20	.608	.515		.283	.115	.056	1.577
22	.754	.407		.194	.134	.063	1.552
24	.937	.425		.220	.145	.048	1.775
26	.997	.246		.164	.104	.029	1.540
28	.734	.201		.082	.089	.014	1.140
30	.608	.089		.082	.029	.014	.822
32	.552	.067		.070	.026	.011	.726
34	.422	.029		.048	.029	.007	.535
36	.362	.018		.056	.029	.007	.472
38	.227			.026	.022	.003	.278
40	.097	.003		.022	.003	.007	.132
42	.052			.007	.007		.066
44	.059			.007	.003	.003	.072
46	.029						.029
48	.011			.007	.007		.025
50	.003				.007	.003	.013
52	.007						.007
54							
56							
Total No. Trees	8.057	5.947	.016	3.541	1.722	.756	20.039
Volume Ft. B.M.	6,731	1,359	3	1,079	675	301	10,148
Average Volume per tree over 12 inches D.B.H.	835	229	191	305	392	398	506

TABLE NO. 3

Sample Acre Stand in Immature Y.P. Type (Y-3)

D.B.H. Inches	Average Number of Trees by Species						Total
	Mature Y	Immature Y	L.P.	D.	W.F.	W.L.	
4-7	.065	7.368	1.710	3.338	1.167	.230	13.878
8-11	.180	5.855	.839	3.092	.871	.230	11.067
12	.230	2.549	.098	.690	.032	.230	3.829
14	.148	1.628	.032	.411	.016	.131	2.366
16	.131	1.184	.016	.032	.016	.098	1.477
18	.180	1.463		.164	.016	.098	1.921
20	.098	1.233		.213	.032	.032	1.608
22	.246	.855		.049	.065	.032	1.247
24	.361	1.003		.246	.032	.032	1.674
26	.345	1.101		.082	.049	.032	1.609
28	.197	.822		.082	.016		1.117
30	.230	.559		.082	.016	.016	.903
32	.394	.345		.131		.016	.886
34	.283	.345		.098			.706
36	.082	.312					.394
38	.115	.115		.016			.246
40	.049	.065					.114
42	.065	.016		.690			.771
44				.723			.723
46	.049	.016					.065
48	.016						.016
50		.032					.032
52	.016						.016
54	.016						.016
56							
Total No. Trees	3.231	13.643	.146	3.709	.290	.717	21.736
Volume Ft. B.M.	2.599	5.139	16	894	143	32	8,826
Av. Vol. per tree over 12" d.b.h.	804	377	108	241	494	440	406

White Fir-Larch-Douglas Fir Type

In this type there is a mixture of all species found on the project and the western yellow pine occurring in it is found usually near the outer edges, or in the drier sites. The type prevails on the cool northerly exposures and in the higher elevations along the watercourses. The trees in this type are of sawtimber size, but being of the species for

which there is a very small market demand, there is little likelihood there will be logging in it in the near future.

Following is a brief summary of the acreage and percentage of area covered in each block, viz.:

Block name	White Fir-Larch-Douglas Fir Type	
	Acreage	Per cent of Block Area
Camp Creek	4,140	23%
Slide Creek	957	14%
Beech Creek	344	34%
Long Creek	1,353	33%
Project	6,794	23%

Lodgepole Pine Type

Two age classes of this type occur on the project, in small isolated tracts. The acreage in each age class is about equally divided between mature and immature. There are only a very small number of trees of sawlog size in this type and logging cannot be done profitably. On areas classified as of this type, the cord volume as well as the B. M. volume, has been computed. The cord volume includes the poles of both diameter classes. Only 1% of the total area covered is in this type.

Non-timbered Types

Seventeen per cent of the total area covered has been, classified as non-timbered, which is briefly summarized as follows:

<u>Type</u>	<u>Acreage</u>
Hardwood	113
Juniper	2,049
Mountain Mahogany	194
Brush	18
Grass	2,831
Barren	<u>118</u>
Total	5,323

Site Classification

The classification of Site quality ranges from IV to VI, the greater portion of the acreage falling in Site IV. The poorer sites are on the steep, dry, rocky, southerly exposures and on the ridge summits wherever the soil is shallow. Juniper and mountain mahogany type areas are classified as Site VI and the other non-timbered types are not classified.

The acreage percentage, considering only the timber types and the woodland types, is indicated for each compartment in the summaries at the bottom of the timber estimate plats which have been prepared in connection with the work on this project.

Description of Timber

Western Yellow Pine

Saw logs of this species will average between 5 and 6 logs per M. ft. B. M. By reference to Tables No. 2 and No. 3 it will be noticed the average volume of trees of all species is stated. The trees average about five logs in height and are quite sound although there is a small amount of defect by stump rot, pitch, fire scars, and spike tops.

It is estimated that the quality of the pine timber will cut from 15% to 20% No. 2 logs and better.

White Fir

The B. M. volume tabulated for this specie is computed for trees 24 inches and less d. b. h. Many of the trees of this species attain diameter sizes of 42" and occasionally more, but trees of such large size are worthless for lumber because of conk rot or windshake. The defect in the larger trees is so pronounced that all trees 26 inches and more in diameter were excluded in computing the timber volume, they are accounted for in the tabulations by number only, under the classification of diseased trees.

Douglas fir

The trees of this species are quite sound and thrifty. The average height is about the same as in the pine trees. Trees have a rather long crown leaving only a short, clear length of the trunk in butt log. Many of the trees are of large diameter sized, -48 inches or more d. b. h. and have rapidly tapering trunks. A small amount of clear lumber may be cut from the larger of the butt logs, but not in appreciable quantities. It is best suited for rough boards and dimension materials.

Reproduction

The density of stand of the reproduction varies from scant to dense and averages about two thirds. On many of the poorer sites the reproduction is entirely absent, due, not doubt, to the extremely shallow, dry condition of the soil. Here, apparently, many of the seedlings get a good start and thrive during the spring and early summer while there is an abundance of rainfall and the soils retains sufficient moisture, but by midsummer the moisture has left and the little trees die. Where the soil is deep and moist there is always a good stand of reproduction and this is especially true in the White-Fir-Larch-Douglas Fir type.

The amount of reproduction in poles of both diameter classes is given in Tables No. 12 to No. 15, inclusive, at the back of this report.

Silvicultural Management

As indicated by the sample acre stand, Table No. 2, the immature Y trees form about 17% of the timber volume of western yellow pine, there being about $\frac{3}{4}$ as many trees of merchantable sawlog size in this age class as there are in the mature class. This proportion of trees of the younger age class is an index of what may be left at the time of

cutting and care should be taken to preserve as many as possible of the smaller poles and saplings now existing.

No special provisions need be made to preserve scenic strips or natural areas, since there are no highways or resorts on the tract. A selection form of cutting as now practiced in the yellow pine regions, is recommended.

Injurious Factors

Mistletoe. Mistletoe is noticeable in the western yellow pine and in the Douglas fir trees, growing in thin stands on the poorer sites. It is, apparently, of only normal occurrence and nowhere exists to an alarming extent.

Beetles. The tract is comparatively free from beetle damage in both the western yellow pine and lodgepole pine species. There are no areas of heavy beetle damage and nowhere is the activity more than normally found in the Blue Mountain region.

Growth and Yield Data

All the western yellow pine trees were tallied in two age classes as mature or immature. Trees of other species were tallied as of one age class. Poles of each species were tallied in two diameter classes, namely, 4"-7" and 8"-11" d. b. h.

The results of the compilation of these pole classes is shown in Tables No. 12 to No. 15 at the back of this report.

The sample acre stand per acre, Tables No. 2 and No.3, preceding this, contain information pertaining to the distribution of the species and density of the various diameter classes.

IV. LOGGING DATA

Camp Creek block represents the better portion of the project and it will be the scene of the first logging operation in the region. Here the Oregon Timber Company owns more than half of the timbered acreage and consequently it is not likely there will be any logging until the time they are ready to exploit their timber. The topography is so rough and broken that it is not possible to log other than by way of Camp Creek, and because of the light stand of timber, it is most feasible to log the Government timber at the time the Company timber is removed.

The locations of the principal railroad spur lines must be confined to the beds of the water courses and since many of the draws have gradients too steep to permit railroad operations it will necessitate some switchback to reach the more remote timber. Because of the steepness of the slopes and rock formation, the cost of grade construction on them will be high and since the timber stand is light it is questionable whether or not this method is feasible for all the area, and it may prove practical to limit them to the better timbered benches and basins.

No quality strips were run on the project. It is estimated that the western yellow pine sawtimber will average about 15% No. 2 logs and better.

V. STATISTICAL SUMMARY

Acreage of Forest Types

The summary of acreages of forest types and age classes is indicated for the national forest lands in Tables No. 4 to No. 7, inclusive, each block having a separate table number. The acreage of alienated lands also is summarized in these tabulations.

Timber Estimate

Only the national forest timber estimates are, tabulated, and the arrangement of the management units corresponds to that of the preceding tables. In addition to the timber estimate, these summaries show the number of diseased white fir trees; the cord volumes of lodgepole pine and western juniper; and the number of snags segregated into four diameter classes. These data are shown under table 8 to 11 inclusive.

Poles

Tables No. 12 to No. 15, inclusive, pertain to the summaries of the number of poles by two diameter classes, namely, 4"-7" and 8"-11" d. b. h.

Project Timber Summary

A brief summary of the timber estimates by block totals is contained in Table No. 16.

TABLE NO. 16
TIMBER SUMMARY FOR PROJECT

Block Name	Net N.F. Acreage	Timber estimate, By Blocks M. Feet B. M.							Total
		Y	LP	D	WF	WL	ES	W	
Camp Creek	789.75	80,523	206	15,167	9,240	9,290	308	71	114,805
Slide Creek	6,769.86	34,148	13	4,418	1,448	1,820	53	-	41,900
Long Creek	4,103.69	12,956	145	6,245	2,344	1,721	178	-	23,589
Beech Creek	1,010.34	6,990	17	1,315	1,225	897	-	-	10,444
Totals	29,673.64	134,617	381	27,145	14,257	13,728	539	71	190,738
Per cent of Timber Stand		70.5%	0.4%	14.2%	7.4%	7.0%	0.5%	-	100%

VI. CONCLUSION

1. By reference to the preceding Summaries and based on the acreage of timberland types for the Government lands, the following averages are obtained:
 - a. Estimated per acre stand of timber, all species, 7,832 feet B. M
 - b. Number of snags per acre, 2.3.
 - c. Number of diseased trees per acre, 0.3.
 - d. Number of small poles, 4"-7" class, per acre 14.6.
 - e. Number of large poles, 8"-11" class, per acre, 10.4.
2. In the mature yellow pine type, the following averages apply:
 - a. Estimated stand per acre, 10,148.
 - b. Immature Y forms 17% of the yellow pine stand.
 - c. The average volume of a mature Y tree is 835 feet B. M., about 26 inches d. b. h.
 - d. The average volume of an immature Y tree is 229 feet B. M., about 20 inches d. b. h.
 - e. Western yellow pine forms 79% of the total stand.

A report pertaining to the costs of the work on this project will be, submitted under separate cover.

Fred A. Matz

Fred A. Matz,
Chief of Timber Survey

Approved: *November 18, 1931*

Carl Ewing

Forest Supervisor

Approved: *Dec. 11, 1931*

Fred Ames

Acting Regional Forester

TABLE NO. 4
ACREAGE SUMMARY OF FOREST TYPES
MIDDLE FOR JOHN DAY RIVER WORKING CIRCLE
CAMP CREEK BLOCK

Section Number	Alienated Land Acres	Yellow pine				WF-Larch-DF			Lodgepole		Hard-Wood Acres	Juniper Acres	Mt. Mahogany Acres	Brush Acres	Grass Acres	Barren Acres	Net N.F. Total Acres	
		Y-4 Acres	Y-3 Acres	Y-2 Acres	Y-1 Acres	FS-3 Acres	FL-2 Acres	FL-1 Acres	LP-2 Acres	LP-1 Acres								
<u>T. 10 S., R. 32 E., W.M.</u>		COMPARTMENT NO. 1																
3	104.00		No Government Land															
4	110.00	273.62					38		6									317.62
8		46.00					136	16										198.00
9	46.00	61.00					95			6								162.00
Comp't 1 Totals	260.00	380.62					269	16	6	6								677.62
<u>T. 10 S., R. 32 E., W.M.</u>		COMPARTMENT NO. 2																
2	315.00				39		1											40.00
3	168.00	94.03			2		168		4									269.03
4	50.00		No Government Land															
9	16.00		No Government Land															
10	36.00		No Government Land															
Comp't 2 Totals	585.00	94.03			41		169		4									308.03
<u>T.10 S., R. 32 E., W.M.</u>		COMPARTMENT NO. 3																
3	10.00	14.00																14.00
8	60.00	68.00					24											92.00
9	298.00	66.00					40			12								118.00
10	244.00	216.00		52			92											360.00
11	503.00		No Government Land															
15	240.00	80.00																80.00
16	160.00	124.00					310	46										480.00
17	136.00	39.00					151	2										192.00
20	70.00		No Government Land															
21	200.00	2.00					78											80.00
Comp't 3 Totals	1,921.00	609.00		52			695	48		12								1,416.00
<u>T.10 S., R. 32 E., W.M.</u>		COMPARTMENT NO. 4																
11	137.00		No. Government Land															
13	298.00	76.00														4		80.00
14	560.00	80.00																80.00
15	320.00		No Government Land															
21	72.00		No Government Land															
22	328.00	136.00					78										2	216.00
23	560.00	65.00					3											80.00
24	500.00	66.00				12									14			80.00
25	14.00		No Government Land															
26	124.00	20.00																20.00
Comp't 4 Totals	2,913.00	443.00				12	81									18	2	556.00

TABLE NO. 4. (Cont'd)
 ACREAGE SUMMARY OF FOREST TYPES
 MIDDLE FORK JOHN DAY RIVER WORKING CIRCLE
 CAMP CREEK BLOCK

Section Number	Alienated Land Acres	Yellow Pine				WF-Larch-DF			Lodgepole		Hard-Wood Acres	Juniper Acres	Mt. Mahogany Acres	Brush Acres	Grass Acres	Barren Acres	Net. N. F. Total Acres
		Y-4 Acres	Y-3 Acres	Y-2 Acres	Y-1 Acres	FL-3 Acres	FL-2 Acres	FL-1 Acres	Lp-2 Acres	Lp-1 Acres							
T. 10 S., R. 32 E., W.M.																	
20	132.00		No	Gov.	Land												
21	208.00	40.00												40			80.00
22	72.00	20.00															22.00
26	276.00	154.00	6									10		14			220.00
27	200.00	359.00	4									16		16			440.00
28	240.00	46.00	8				24				2						80.00
34	40.00	18.00	22														50.00
35	174.00	11.00	58									3					72.00
Comp't 5 Totals	1,342.00	648.00	98			93	24				2	29		70			964.00
T. 10 S., R. 32 E., W.M.																	
24	60.00	No	Gov.	Land													
25	278.00	112.00	89		5							32		2			240.00
36		36.00	2		6												44.00
Comp't 6 Totals	338.00	148.00	91		5	6						32		2			284.00
T. 10 S., R. 32 E., W.M.																	
25	108.00	No	Gov.	Land													
36		350.00	5		6							6	4	117			488.00
Por. Twp. Tables	108.00	350.00	5		6							6	4	117			488.00
T. 11 S., R. 32 E., W.M.																	
1	298.00	149.69				6						62					221.0069
12	32.00	14.00				8						12					34.00
Por. Twp. Totals	330.00	163.69				14						74	4				255.69
Comp't 7 Totals	438.03	513.69	5		6	14						80	8	117			743.69
T. 10 S., R. 32 E., W.M.																	
35	200.00		46			6						18					70.00
36		96.00										4		8			108.00
Por. Twp. Totals	200.00	96.00	46			6						22		8			178.00
T. 11 S., R. 32 E., W.M.																	
1		28.00										42					70.00
2	86.12	334.88	2									69		31			436.88
11	160.00	64.00															64.00
12	128.00	No	Gov.	Land													
Por. Twp. Totals	374.12	426.88	2									111		31			570.88
Comp't 8 Totals	574.12	522.88	48			6						133		39			748.88
T. 10 S., R. 32 E., W.M.																	
20	126.00	No	Gov	ern't	Land												
28	320.00	No	Gov	ern't	Land												
29	560.00	32.00	2									26					80.00
30	32.00	38.00				20						20					80.00
31	80.00	46.00				22						16					62.00
32	320.00	121.00	38	14	12	8	60					65		2			320.00
33	332.00	150.00	23		13	32	4					22	2	20			266.00
34	40.00	71.00	167		46	8								6			298.00
35	80.00		8														8.00
Por. Twp. Totals	1,890.00	458.00	238	14	71	90	64					149	2	28			1,114.00

TABLE NO. 4 (Cont'd)

ACREAGE SUMMARY OF FOREST TYPES
MIDDLE FORK JOHN DAY RIVER WORKING CIRCLE
CAMP CREEK BLOCK

Section Number	Alienated Land Acres	Yellow Pine				WF-Larch-DF			Lodgepole		Hard-Wood Acres	Juniper Acres	Mt. Mahogany Acres	Brush Acres	Grass Acres	Barren Acres	Net.N.F. Total Acres
		Y-4 Acres	Y-3 Acres	Y-2 Acres	Y-1 Acres	FL-3 Acres	FL-2 Acres	FL-1 Acres	Lp-2 Acres	Lp-1 Acres							
T.11 S., R. 32 E., W.M.																	
4		12.00										25					37.00
5	176.35	34.35	10				4					20					88.35
6	140.00		No Government Land														
Por.Twp.Totals	316.35	46.35	10				4					45					105.35
Comp's 9 Totals	2,206.35	504.35	248	14	71	90	68					194	2		28		1,219.35
T.10 S., R. 32 E., W.M.																	
COMPARTMENT NO. 10																	
33	28.00	6.00	2											6			14.00
34	120.00	38.00	48		6												92.00
35	36.00		No Government Land														
Por.Twp.Totals	184.00	44.00	50		6									6			106.00
T.11 S., R. 32 E., W.M.																	
3	216.50	83.48	52												5		140.48
4	314.00	106.32	40		8	4						54		16			228.32
5	276.00	52.00			4							8					64.00
6	12.00		No Government Land														
8	80.00		No Government Land														
9	32.00	6.00										6					12.00
Por.Twp.Totals	930.50	247.80	92		12	4						68		21			444.80
Comp't 10 Totals	1,114.50	291.80	142		18	4						68		27			550.80
T.11 S., R. 32 E., W.M.																	
COMPARTMENT NO. 11																	
2	40.00		No Government Land														
3	106.00	104.00										8					112.00
4	6.00		No Government Land														
8	300.00	80.00				6	76										162.00
9	298.00	224.00				16						12		30			282.00
10	76.00	68.00			3									3			74.00
16	167.00	167.00	6			66						8		11			328.00
17	402.00	58.00	2			102											162.00
18	52.00	2.00				58											60.00
19		4.00				22										4	30.00
Comp't 11 Totals	1,280.00	707.00	78		3	270	76					28		48			1,210.00
T.11 S., R. 32 E., W.M.																	
COMPARTMENT NO. 12																	
16			76			10						8					94.00
17		24.00										6	8				38.00
19		6.00				2											12.00
20		100.00	204			194						34		2	2		554.00
21		10.00	224			34						22	4	2	20		298.00
29		1.00	6									3		4			10.00
Comp't 12 totals		141.00	510			240						73	12	4	26		1,006.00

TABLE NO.4 (Continued)
 ACREAGE SUMMARY OF FOREST TYPES
 MIDDLE FORK JOHN DAY RIVER WORKING CIRCLE
 CAMP CREEK BLOCK

Section Number	Alienated Land Acres	Yellow Pine				WF-Larch-DF			Lodgepole		Hard Wood Acres	Juniper Acres	Mt. Mahogany Acres	Brush Acres	Grass Acres	Barren Acres	Net. N. F. Total Acres	
		Y-4 Acres	Y-3 Acres	Y-2 Acres	Y-1 Acres	FL-3 Acres	FL-2 Acres	FL-1 Acres	Lp-2 Acres	Lp-1 Acres								
COMPARTMENT NO. 13																		
T.11 S., R. 32 E., W.M.																		
9		16.00															16.00	
10		24.00															24.00	
15		48.00	16		2							6				2	74.00	
16		112.00	50			8						7	2			39	218.00	
21		170.00	90			22		4				18	2	2		6	314.00	
22		64.00	60			12	2					12					150.00	
28	2.00	22.00							6								28.00	
Comp't 13 totals	2.00	456.00	216		2	42	2	4	6			43	4	2		47	824.00	
COMPARTMENT NO. 14																		
T.11 S. R. 32 E., W.M.																		
10	70.00	222.00															222.00	
15		278.00	41	16	14	20						8	20			13	418.00	
22		2.00	272		6	10	90					12	14			34	440.00	
23		34.00	2				4										40.00	
26		10.00	6			8	24										48.00	
27	28.00		52			40	8										100.00	
Comp't 14 totals	98.00	546.00	373	16	20	78	126					20	34			47	1,268.00	
COMPARTMENT NO. 15																		
T.11 S., R. 32 E., W.M.																		
2	20.00		No Government Land															
3	10.00		No Government Land															
10	94.00	40.00				24										6	16	80.00
11	40.00	286.00				24						14	12			14	40	376.00
12	80.00	80.00										12						92.00
13	195.00	182.00										20					14	222.00
14	200.00	208.00	124			38						52	4					440.00
15	80.00	68.00				2							8					78.00
22			20										4					24.00
23	160.00	340.00				70	10					20						440.00
24	240.00	96.00				108						12						220.00
25	240.00		No Government Land															
26		46.00	36				114											196.00
Comp't 15 totals	1,359.00	1,346.00	180			266	124					130	28			20	70	2,168.00
COMPARTMENT NO. 16																		
T.11 S., R. 32 E., W. M.																		
12		250.00	12									12						274.00
13	45.00	72.00	48			12	26					20						178.00
24	80.00	40.00				60												100.00
25	85.00		No Government Land															
Comp't 16 totals	210.00	362.00	60			72	26					32						552.00

TABLE NO. 4 (Cont'd)
 ACREAGE SUMMARY OF FOREST TYPES
 MIDDLE FORK JOHN DY RIVER WORKING CIRCLE
 CAMP CREEK BLOCK

Section Number	Alienated Land Acres	Yellow pine				WF-Larch-DF			Lodgepole		Hard Wood Acres	Juniper Acres	Mt. Mahogany Acres	Brush Acres	Grass Acres	Barren Acres	Net N. F. Total Acres
		Y-4 Acres	Y-3 Acres	Y-2 Acres	Y-1 Acres	FL-3 Acres	FL-2 Acres	FL-1 Acres	Lp-2 Acres	Lp-1 Acres							
<u>T.11 S.R. 32 E., W.M.</u>		COMPARTMENT NO. 17															
21		8.00	6									2	4				20.00
22		24.00											2				26.00
25	275.00					No Government Land											
26	80.00		252				20								16		316.00
27	412.00	40.00	48		4							6	2				100.00
28	92.00	72.00	56						6			6	20				186.00
33	26.00					No Government Land											
34	278.00		50		2							8					92.00
35	230.00		150									44	4				260.00
36	142.00																
Comp' 17 Totals	1,535.00	144.00	562		6	120	20		6			94	32		16		1,000.00
<u>T.11 S. R. 32 E., W.M.</u>		COMPARTMENT NO. 18															
20			66										18	2			86.00
21		4.00	4														8.00
28	146.00	44.00	8						24								186.00
29	280.00	110.00	66									18					350.00
30		20.00	5														172.00
31	24.00					No Government Land											
32	116.00	52.00	4														56.00
33	100.00																22.00
Comp' 18 Totals	666.00	230.00	153			419	16		24			36	2				880.00
<u>T. 11 S., R. 32 E., W. M.</u>		COMPARTMENT NO. 19															
32	16.00					No Government Land											
33	394.00	2.00	2								8						98.00
34	162.00										42						108.00
35																	20.00
Por. Twp. Totals	572.00	2.00	2			172					50						226.00
<u>T 12 S., R. 32 E., W. M</u>		COMPARTMENT NO. 20															
2	120.00	24.00															40.00
3	4.00	41.00	11									3					236.00
4	80.00	284.40							23	23		3			31		554.40
5		6.00															6.00
8						Off Project											
9	60.00	32.00															72.00
Por. Twp. Totals	264.00	387.40	11			427			23	23		6			31		908.40
Comp't 19 Totals	836.00	389.40	13			599			23	73		6			31		1,134.40
<u>T. 11 S., R. 32 E., W.M.</u>		COMPARTMENT NO. 20															
25	40.00					No Government Land											
35	90.00		28														40.00
36	498.00					No Government Land											
Por. Twp. Totals	628.00		28			12											40.00
<u>T. 12 S., R. 32 E., W. M.</u>		COMPARTMENT NO. 20															
2	240.00	92.98									12						238.98
Comp't 20 Totals	868.00	92.98	28			146					12						278.98
BLOCK TOTALS																	
20 Comp'ts	18,546.0	8,569.75	2,857	76	237	3,580	546	14	77	89	2	998	122	6	536	80	17,789.75

TABLE NO. 5
ACREAGE SUMMARY OF FOREST TYPES
MIDDLE FORK JOHN DAY RIVER WORKING CIRCLE
SLIDE CREEK BLOCK

Section Number	Alienated Land Acres	Yellow Pine				WF-Larch-DF			Lodgepole		Hard-wood Acres	Juniper Acres	Mt. Mahogany Acres	Brush Acres	Grass Acres	Barren Acres	Net N. F. Total Acres
		Y-4 Acres	Y-3 Acres	Y-2 Acres	Y-1 Acres	FI-3 Acres	FI-2 Acres	FI-1 Acres	Lp-2 Acres	Lp-1 Acres							
<u>T. 9 S., R. 31 E., W.M.</u>		COMPARTMENT NO. 1															
21		24.00	2			86						37			2		151.00
22	40.00			No.	Gov.	Land											
Comp't 1 Totals		40.00	24.00	2		86						37			2		151.00
<u>T. 9 S., R. 31 E., W.M.</u>		COMPARTMENT NO. 2															
21		13.00										11					24.00
22	240.00	260.00	22	24		21						21			12		360.00
27	172.00	121.00	28	70		12						38			37		306.00
28		2.00	2									20					24.00
Comp't 2 Totals		412.00	396.00	52	94	33						90			49		714.00
<u>T. 9 S., R. 31 E., W.M.</u>		COMPARTMENT NO. 3															
27	28.00	33.00	25	7								59	2		8		134.00
28			1									24					25.00
33		48.00	96	1								50			17		212.00
34		205.00	232	16								17	34		136		640.00
Por.Twp.Totals		28.00	286.00	354	24							150	36		161		1,011.00
<u>T. 10 S., R.31 E., W.M.</u>		COMPARTMENT NO. 3															
3	8.00	8.05	170			58							4		42		282.05
4		99.00				8									32		139.00
Por.Twp.Totals		8.00	107.05	170		66							4		74		421.05
Comp't 3 Totals		36.00	393.05	524	24	66						150	40		235		1,422.05
<u>T.10 S., R. 31 E., W.M.</u>		COMPARTMENT NO. 4															
3	112.00	46.00	126			16									50		238.00
4		16.00	6			6											28.00
9		4.00															4.00
10	306.00	94.00				90						4			30		218.00
11			80												46		126.00
15		12.00					8										20.00
Comp't 4 Totals		418.00	172.00	212		112	8					4			126		634.00
<u>T. 10 S., R.31 E., W.M.</u>		COMPARTMENT NO. 5															
10	54.00	8.00													4		12.00
11		14.00	88												60		162.00
13		124.00	4			48						4			40		220.00
14	280.00	128.00	12			8						30			162		310.00
15	40.00	216.00										14			36		282.00
23		36.00	14												20		84.00
24		72.00	6			96							16		40		230.00
Por.Twp. Totals		374.00	598.00	124		152						48	16		362		1,300.00

TABLE No. 5 (cont'd)
 ACREAGE SUMMARY OF FOREST TYPES
 MIDDLE FORK JOHN DAY RIVER WORKING CIRCLE
 SLIDE CREEK BLOCK

Section Number	Alienated Land Acres	Yellow Pine				WF-Larch-DF			Lodgepole		Hard-wood Acres	Juniper Acres	Mt. Mahogany Acres	Brush Acres	Grass Acres	Barren Acres	Net.N. F. Total Acres
		Y-4 Acres	Y-3 Acres	Y-2 Acres	Y-1 Acres	FL-3 Acres	FL-2 Acres	FL-1 Acres	Lp-2 Acres	Lp-1 Acres							
T.10 S. R 32 E.W.M.																	
19	280.00	49.00				18	4		61			8					140.00
20	10.00	No	Gov.	Land													
30	60.00	No.	Gov.	Land													
Por.Twp. Totals	350.00	49.00				18	4		61			8					140.00
Comp't 5 Totals	724.00	647.00	124			170	4		61			56	16		362		1,440.00
T.10 S. R. 31 E., W.M.																	
COMPARTMENT NO. 6																	
11		32.00										2			46		80.00
12															10		10.00
13		140.00	12			60						32	8		68		320.00
14		10.00													40		50.00
Por.Twp. Totals		182.00	12			60						34	8		164		460.00
T.10 S., R.32 E.W.M.																	
17	184.00	76.00				52											128.00
18	236.00	92.00	22			24									4	4	206.00
19	40.00	70.30	4			40	8	30				12			3		167.30
20	302.00	No	Gov.	Land													
Por.Twp. Totals	762.00	238.30	26			116	8	30				64	8		7	4	501.30
Comp't 6 Totals	762.00	420.30	38			176	8	30				98	16		171	4	961.30
T.10 S., R 31 E., W.M																	
COMPARTMENT NO. 7																	
11	120.00	80.00	2	2											68		152.00
12	280.00	126.00	60			8									156		350.00
13		20.00	32									24			24		100.00
Por.Twp. Totals	400.00	226.00	94	2		8						24			248		602.00
T.10 S., R. 32 E., W.M.																	
7	160.00	156.00				40						18			14	34	262.00
8	40.00	No	Gov.	Land													
18	44.00	25.71	20			94						18					157.71
Por.Twp. Totals	244.00	181.71	20			134						36			14	34	419.71
Comp't 7 Totals	644.00	407.71	114	2		142						60			262	34	1,021.71
T.10 S., R. 32 E., W.M.																	
COMPARTMENT NO. 8																	
6	160.00	70.01										4			90		164.01
7	120.00	27.79				42						4			28		101.79
8	100.00	70.00				2	78										150.00
Comp't 8 Totals	380.00	167.80				44	78					8			118		415.80
BLOCK TOTALS																	
8 Compartments	3,416.00	2,627.86	1,066	120		829	98	30	61			503	72		1,325	38	6,789.86
Percentage		(50%)	(14%)	(1%)	(29%)				

TABLE No. 6
ACREAGE SUMMARY OF FOREST TYPES
MIDDLE FORK JOHN DAY RIVER WORKING CIRCLE
LONG CREEK BLOCK

Section number	Alienated Land Acres	Yellow pine				WF-Larch-DF			Lodgepole		Hard-wood Acres	Juniper Acres	Mt. Mahogany Acres	Brush Acres	Grass Acres	Barren Acres	Net. N. F. Total Acres
		Y-4 Acres	Y-3 Acres	Y-2 Acres	Y-1 Acres	FL-3 Acres	FL-2 Acres	FL-1 Acres	Lp-2 Acres	Lp-1 Acres							
T. 9 S., R. 31 E. W.M.																	
21	160.00	7.00	38									90			170		305.00
28		140.00	54			70						287					551.00
33		52.00	45			20						25			126		268.00
Por. Twp. Totals	160.00	199.00	137			90						402			296		1,124.00
T. 10 S., R. 31 E., W.M.																	
4	120.00	16.60	76			16								248			356.60
9		162.00	6			64						34		370			636.00
10		4.00										4		42			50.00
Por. Twp. Totals	120.00	182.60	82			80						38		660			1,042.60
T. 10 S., R. 32 E., W. M.																	
19			2			8						6					16.00
30	228.00	154.62	2			8						76					240.62
31	320.00	120.66					44					14					178.66
Por. Twp. Totals	548.00	275.28	4			16	44					96					435.28
T. 11 S., R. 32 E., W.M.																	
6	447.45		No Government Land														
7	294.92	56.00	2			288	4					6		4			360.00
8	20.00		2			21	43			12							78.00
17	38.00		No Government Land														
18	443.24	6.00				76							12	6			100.00
19		72.12	118			355				68							613.12
30		4.69				336						6		4			350.69
Por. Twp. Totals	1,243.61	138.81	122			1,076	47			80		12		12	14		1,501.81
BLOCK TOTALS																	
Percentage	22,071.61	795.69	345			1,262	91			80		548		12	970		4,103.69
	(28%) (33%) (2%) (37%)																

TABLE No. 7
ACREAGE SUMMARY OF FOREST TYPES
MIDDLE FORK JOHN DAY RIVER WORKING CIRCLE
BEECH CREEK BLOCK

Section number	Alienated Land Acres	Yellow Pine				WF-Larch-DF			Lodgepole		Hard-wood Acres	Juniper Acres	Mt. Mahogany Acres	Brush Acres	Grass Acres	Barren Acres	Net.N.F. Total Acres
		Y-4 Acres	Y-3 Acres	Y-2 Acres	Y-1 Acres	FL-3 Acres	FL-2 Acres	FI-1 Acres	Lp-2 Acres	Lp-1 Acres							
T. 9 S., R. 31 E., W. M.																	
30		3.00	16			84						29					132.00
31	176.00	226.98	20			186				6		8					446.98
32	348.00	8.00	40			56											104.00
Por. Twp. Totals	524.00	237.98	76			326				6		37					682.98
T. 12 S., R. 32 E., W. M																	
5	586.00	19.36				18						2					39.36
9	220.00	216.00										72					288.00
Por. Twp. Totals	806.00	235.36				18						74					327.36
BLOCK TOTALS																	
	1,330.00	473.34	76			344				6		111					1,010.34
Percentage		54%				34%		0.6%				11.4%					
PROJECT TOTALS																	
4 Blocks 11	25,363.61	12,466.64	4,344	196	237	6,015	735	44	138	175	113	2,049	194	18	2,831	118	29,673.64
Percentage			59%				23%			1%							17%

TABLE NO. 8
SUMMARY OF TIMBER ESTIMATES
MIDDLE FORK JOHN DAY RIVER WORKING CIRCLE
CAMP CREEK BLOCK

Section Number	Acreage N. F. Acres	M. Feet B.M for Species			LP	D	WF	WL	ES	W	Total	No. Diseased Trees	Cord Volume		Number of Snags, All Species					
		Yellow Pine											LP	WJ	12"-20"	22"-30"	32"-40"	42"+	Total	
		Mature	Immature	Total																
COMPARTMENT NO. 1																				
T. 10 S., R. 32 E., W.M.																				
4	317.62	761	151	912		401	225	205			1,743	135			555	217			772	
8	198.00	300	1	301	2	209	298	110			920	120			550	174	20		744	
9	162.00	343	5	348	3	169	283	202			1,005	183			564	233	10		807	
Comp't 1 Totals	677.62	1,404	157	1,561	5	779	806	517			3,688	438			1,669	624	30		2,323	
COMPARTMENT NO. 2																				
T. 10 S., R. 32 E., W. M																				
2	40.00		12	12		24		2			38									
3	268.03	440	64	504		383	159	87			1,133	30			433	167	10		610	
Comp't 2 Totals	308.03	440	76	516		407	159	89			1,171	30			433	167	10		610	
COMPARTMENT NO. 3																				
T. 10 S., R. 32 E., W. M.																				
3	14.00	72	3	75		19	4	2			100				50	20			70	
8	92.00	389	89	478		92	81	43			694	10		2	154	70	20		244	
9	118.00	268	47	315		92	47	163			617				382	149			531	
10	360.00	1,091	233	1,324		618	135	86			2,163				193	202	30		425	
15	80.00	403	46	449		51	88	50			638	20			60	90	20		170	
16	480.00	1,456	81	1,537	3	241	662	328		15	2,786	102			1,371	488	10		1,869	
17	192.00	198	137	353	1	217	272	131		56	1,012				450	174	10		634	
21	80.00	29	29	29		75	360	70			534	100		60	420	120	20		560	
Comp't 3 Totals	1,416.00	3,906	636	4,542	4	1,405	1,649	873		71	8,544	232		62	3,080	1,313	110		4,503	
COMPARTMENT NO. 4																				
T. 10 S., R. 32 E., W.M.																				
13	80.00	319	18	337							337				80	30	10	10	150	
14	80.00	65	9	74							74				20	10			30	
22	216.00	1,690	229	1,919		103	572	179			2,773	217			776	156	46		978	
23	80.00	556	103	659		31					690				10	31	20	20	81	
24	80.00	277	27	304		43					347				20	70			90	
26	20.00	86	61	147							147				5	10	5	5	25	
Comp't 4 Totals	556.00	2,993	447	3,440		177	572	179			4,368	217			911	297	91	35	1,334	
COMPARTMENT NO. 5																				
T. 10 S., R. 32 E., W.M																				
21	80.00	243	107	350		17		18			385				60	80			140	
22	22.00	242	24	266		2	8				276				74	28	23		125	
26	220.00	853	334	1,187		18					1,205			21	133	75	25	5	258	
27	440.00	3,141	787	3,928		101	26	39			4,094	30		123	466	302	97	21	886	
28	80.00	351	166	517		53	147	71			788	54			200	48	24		272	
34	50.00	209	84	293			1	2			295				36			36	72	
35	72.00	176	35	211	1	41					253			2	30	15			45	
Comp't 5 Totals	964.00	5,215	1,537	6,752	1	232	182	130			7,297	84		146	999	548	189	62	1,798	

TABLE No. 8 (Cont'd)
SUMMARY OF TIMBER ESTIMATES
MIDDLE FORK JOHN DAY RIVER WORKING CIRCLE
CAMP CREEK BLOCK

Section number	Acreage N. F. Acres	M. Feet B.M. for Species			LP	D	WF	WL	ES	W	Total	No. Diseased Trees	Cord Volume		Number of Snags, All Species				
		Yellow Pine											LP	WJ	12"-20"	22"-30"	32"-40"	42"+	Total
		Mature	Immature	Total															
COMPARTMENT NO. 16																			
T.11 S., R. 32 E., W. M.																			
12	274.00	1,117	157	1,274		130	19	56			1,479	48		42	215	149	39	403	
13	178.00	455	162	617		147	133	25			922	36		121	172	79		251	
24	100.00	83	92	175	1	49	123	70			418	30			50	37	1	88	
Comp't 16Totals	552.00	1,655	411	2,066	1	326	275	151			2,819	114		163	437	265	40	742	
COMPARTMENT NO. 17																			
T. 11 S., R. 32 E., W. M.																			
21	20.00	102	87	189		5	1	18			213	32			6	6	19	31	
22	26.00	168	45	213		17	6	3			239			8	8	8		16	
26	316.00	878	366	1,244		280	58	72			1,654	63		57	345	287	26	658	
27	100.00	286	482	788		79		11			858				30	11	34	75	
28	186.00	707	441	1,148	2	115	51	132			1,448	10	7	77	124	106	39	309	
34	92.00	236	186	422	16	3	1	207			640			8	139	20	41	206	
35	260.00	1,425	396	1,821	8	145	158	204			2,336	107		14	217	101	58	385	
Comp't 17Totals	1,000.00	3,802	2,003	5,805	26	644	275	647			7,397	212	7	164	861	530	202	1,680	
COMPARTMENT NO. 18																			
T. 11 S., R. 32 E., W. M.																			
20	86.00	93	293	386		94		2			482						12	24	
21	8.00	15	19	34		5	1	2			42								
28	186.00	232	103	335	10	117	118	358			938	69	31		850	316	4	1,170	
29	350.00	1,242	313	1,555	3	369	714	483	2		3,125	550		166	402	302	47	751	
30	172.00	801	250	1,051	8	527	413	182			2,181	329			702	84	71	857	
32	56.00	110	148	258	10	25	250	116			659	60			259	42	26	327	
33	22.00					7	1				8								
Comp't 18Totals	880.00	2,493	1,126	3,619	31	1,144	1,497	1,143	2		7,436	1,008	31	166	2,213	744	160	3,129	
COMPARTMENT NO. 19																			
T.11 S., R. 32 E., W. M.																			
33	98.00	51	27	78	1	30		233			342				100	4		104	
34	108.00		19	19			3	280			302				260	304	76	640	
35	20.00	42	86	128	9	5		77			219				123			123	
Por. Twp. Totals	226.00	93	132	225	10	35	3	590			863				483	308	76	867	
COMPARTMENT NO. 20																			
T. 12 S., R. 32 E., W. M.																			
2	40.00	216	11	227		44	11	62			344				11	11		22	
3	236.00	356	194	550	1	304	254	261	130		1,500	171		5	518	309	60	887	
4	554.40	2,247	196	2,443	38	580	254	505			3,820	350	60	5	712	425	98	1,235	
5	6.00	36	2	38		8		4			50	6		2					
9	72.00	469	46	515	3	100	216	79			913			46	157	79	14	264	
Por. Twp. Totals	908.40	3,324	449	3,773	42	1,036	735	911	130		6,627	527	60	58	1,398	824	172	2,408	
Comp't 19Totals	1,134.40	3,417	581	3,998	52	1,071	738	1,501	130		7,490	527	60	58	1,881	1,132	248	3,275	
COMPARTMENT NO. 20																			
T. 11 S., R. 32 E., W. M.																			
35	40.00	129	178	307	5	32		60			404				45	22	67	156	
T. 12 S., R. 32 E., W. M.																			
2	238.98	668	66	734	12	381	58	521			1,706	49			182	130	30	342	
Comp't 20Totals	278.98	797	244	1,041	17	413	58	581			2,110	49			227	152	97	498	
BLOCK TOTALS																			
20 Compartments	17,789.75	58,873	21,650	80,523	206	15,167	9,240	9,290	308	71	114,805	4,389	104	2,171	20,441	11,027	2,650	567	34,685

TABLE No. 9
SUMMARY OF TIMBER ESTIMATES
MIDDLE FORK JOHN DAY RIVER WORKING CIRCLE
SLIDE CREEK BLOCK

Section Number	Acreage N.F. Acres	M. Feet B.M.for Species			LP	D	WF	WL	ES	W	Total	No. Diseased Trees	Cord Volume		Number of Snags, All Species				
		Yellow Pine											LP	WJ	12"-20"	22"-30"	32"-40"	42"+	Total
Mature	Immature	Total																	
T. 9 S., R. 31 E., W. M.																			
21	151.00	617	217	834		102	COMPARTMENT NO. 1					8	159	107	57		323		
T. 9 S., R. 31 E., W. M.																			
21	24.00	195	135	330		45	1			376			16	36	10		62		
22	360.00	2,166	465	2,631		182	39	62		2,914		85	151	171	48		401		
27	306.00	1,167	272	1,439		216	11	33		1,699	27	62	49	70	47	31	196		
28	24.00	24	10	34						34			4	4	30		4		
Comp't 2 Totals	714.00	3,552	882	4,434		443	51	95		5,023	27		147	216	281	105	61	663	
T. 9 S., R. 31 E., W. M.																			
27	134.00	373	175	548		27	COMPARTMENT NO. 3			575		24	23	24	27		74		
28	25.00																		
33	212.00	479	514	993		158				1,151	7	15	22	52	33		107		
34	640.00	2,577	1,062	3,639		167	13			3,819		67	170	200	107	39	516		
Por. Twp. Totals	1,011.00	3,429	1,751	5,180		352	13			5,545	7		106	215	276	167	39	697	
T. 10 S., R. 31 E., W. M.																			
3	282.05	515	923	1,438		167	155	129		1,889	84		30	104	37		171		
4	139.00	353	414	767		126	37	26		956	18		46	48	10	9	113		
Por. Twp. Totals	421.05	868	1,337	2,205		293	192	155		2,845	102		76	152	47	9	284		
Comp't 3 Totals	1,432.05	4,297	3,088	7,385		645	205	155		8,390	109		106	291	428	214	48	981	
T. 10 S., R. 31 E., W. M.																			
3	238.00	1,015	652	1,667	1	257	105	153		2,183	152		144	186	104	11	445		
4	28.00	33	18	51		12	2			65			9	2	1	1	13		
9	4.00	37	23	60		6	1	3		70			3				3		
10	218.00	658	411	1,069		693	133	127		2,022	33		310	214	115	20	657		
11	126.00	142	542	684		1		5		690			31	31	12		74		
15	20.00																		
Comp't 4 Totals	634.00	1,8885	1,646	3,531	1	969	241	288		5,030	185		497	433	230	32	1,192		
T. 10 S., R. 31 E., W. M.																			
10	12.00	48	1	49		3	4			56	6		6	12			18		
11	162.00	172	422	594		3	23	56		676			28		20		48		
13	220.00	484	314	798	1	133	64	97	7	1,100		53	464	252	67		783		
14	310.00	819	467	1,286		98	15	52		1,451		24	114	32	7		153		
15	282.00	1,665	462	2,127		221	10	27		2,385		30	171	54	10		235		
23	84.00	355	163	518		13				531		17	66	17	90	53	226		
24	230.00	376	277	633	1	139	42	146		981	29	10	800	138	34		972		
Por. Twp. Totals	1,300.00	3,919	2,106	6,025	2	610	158	378	7	7,180	35		134	1,649	505	228	53	2,435	
T. 10 S., R. 32 E., W. M.																			
19	140.00	237	190	427	2	296	4	93		822		132	458	81	158	22	719		
Comp't 5 Totals	1,440.00	4,156	2,296	6,452	4	906	162	471	7	8,002	35		266	2,107	586	386	75	3,154	

TABLE No. 9 (Continued)
SUMMARY OF TIMBER ESTIMATES
MIDDLE FORK JOHN DAY RIVER WORKING CIRCLE
SLIDE CREEK BLOCK

Section Number	Acreage N. F. Acres	M. Feet B.M. for Species			LP	D	WF	WL	ES	W	Total	Total Diseased Trees	Cord volume		Number of Snags, All Species					
		Yellow Pine											LP	WJ	12"-20"	22"-30"	32"-40"	42"+	Total	
		Mature	Immature	Total																
COMPARTMENT NO. 6																				
T. 10 S., R. 31 E., W. M.																				
11	80.00	209	84	293			53	2			348			12	12	8			32	
12	10.00																			
13	320.00	1,173	240	1,413	1	185	114	116	8		1,837	80	7	395	111	45	9		560	
14	50.00	100	23	123				6			129			20	5	3			28	
Por. Twp. Totals	460.00	1,482	347	1,829	1	185	167	124	8		2,314	80	7	427	128	56	9		620	
COMPARTMENT NO. 7																				
T. 10 S., R. 32 E., W. M.																				
17	128.00	193	28	221	1	116	35	70			443	8		249	172				421	
18	206.00	761	338	1,099		64	38	101	11		1,313		41	542	124	20			686	
19	167.30	207	159	366		222	1	19			608		9	520	151	82	25		778	
Por. Twp. Totals	501.30	1,161	525	1,686	1	402	74	190	11		2,364	8	50	1,311	447	102	25		1,885	
Comp't 6 Totals	961.30	2,643	872	3,515	2	587	241	314	19		4,678	88	57	1,738	575	158	34		2,505	
COMPARTMENT NO. 8																				
T. 10 S., R. 31 E., W. M.																				
11	152.00	559	159	718			1	3			722			18	18	39	8		83	
12	350.00	1,360	473	1,833		19	29	41			1,922	65		67	83	21	21		192	
13	100.00	416	284	700		37		9			749			8	130	9			147	
Por. Twp. Totals	602.00	2,335	916	3,251		56	30	53			3,390	65		93	231	69	29		422	
T. 10 S., R. 32 E., W. M.																				
7	262.00	2,049	250	2,299	2	195	74	62			2,632	2	58	391	241	143			775	
18	157.71	502	148	650	3	194	147	143	27		1,164	113	26	546	249	22			817	
Por. Twp. Totals	419.71	2,551	398	2,949	5	389	221	205	27		3,796	115	84	937	490	165			1,592	
Comp't 7 Totals	1,021.71	4,886	1,314	6,200	5	445	251	258	27		7,186	180	84	1,030	721	234	29		2,014	
T. 10 S., R. 32 E., W. M.																				
6	164.01	1,034	41	1,075		85	26	30			1,216			95	59	21	8		183	
7	101.79	165	77	242		81	91	49			463			274	45				319	
8	150.00	418	62	480	1	155	104	71			811	18		510	146	10			666	
Comp't 8 Totals	415.80	1,617	180	1,797	1	321	221	150			2,490	18		879	250	31	8		1,168	
Block Totals																				
8 Compartments	6,769.66	23,653	10,495	34,148	13	4,418	1,443	1,820	53		41,900	642	668	6,917	3,381	1,415	287		12,000	

TABLE No. 10
SUMMARY OF TIMBER ESTIMATES
MIDDLE FORK JOHN DAY RIVER WORKING CIRCLE
LONG CREEK BLOCK

Section Number	Acreage N.F. Acres	M. Feet B.M. for Species			LP	D	WF	WL	ES	W	Total	No. Diseased Trees	Cord Volume		Number of Snags, All Species				
		Yellow Pine											LP	WJ	12"-20"	22"-30"	32"-40"	42"+	Total
		Mature	Immature	Total															
T. 9 S., R. 31 E., W. M.																			
21	305.00	242	109	351		3	4			358		8	11	3	10			24	
28	551.00	1,300	749	2,049		314	385	17		2,765	385	6	54	172	55	8		289	
33	268.00	808	417	1,225		150	109	32		1,516	176	19	50	27	24	7		108	
Por Twp. Totals	1,124.00	2,350	1,275	3,625		467	494	53		4,639	561	33	115	202	89	15		421	
T. 10 S., R. 31 E., W. M.																			
4	356.60	430	706	1,136		220	78	65		1,499	185		31	38	25			94	
9	636.00	1,087	952	2,039	1	379	192	138	1	2,750	221	113	210	103	26	23		362	
10	50.00	17	15	32		3				35			6	2	4			12	
Por. Twp. Totals	1,042.60	1,534	1,673	3,207	1	602	270	203	1	4,284	407	113	247	143	55	23		468	
T. 10 S., R. 32 E., W. M.																			
19	16.00	12	9	21		17				32		18		13				13	
30	240.62	994	266	1,260	15	379		15		1,669		226	95	50	30	48		223	
31	178.66	618	295	913	3	221	78	101		1,316	25	26	832	345	103			1,280	
Por. Twp. Totals	435.28	1,624	570	2,194	18	617	78	116		3,023	25	270	927	408	133	48		1,516	
T. 11 S., R. 32 E., W. M.																			
7	360.00	651	56	707	20	1,259	329	263		2,578	106	33	785	777	328			1,890	
8	78.00	13	12	25	3	76	93	31		228	15		547	648	9			1,204	
18	100.00	249	25	274	1	591	57	55		978	65		62	115	68	11		256	
19	613.12	1,725	930	2,655	12	2,293	53	405	5	5,423	20		121	100	61	57		339	
30	350.69	222	47	269	90	340	970	595	172	2,436	782		1,365	314	95			1,774	
Por. Twp Totals	1,501.81	2,860	1,070	3,930	126	4,559	1,502	1,349	177	11,643	988	33	2,880	1,954	561	68		5,463	
Block Totals																			
	4,103.69	8,368	4,588	12,956	145	6,245	2,344	1,721	178	23,589	1,981	449	4,169	2,707	838	154		7,868	

TABLE No. 11
SUMMARY OF TIMBER ESTIMATES
MIDDLE FORK JOHN DAY RIVER WORKING CIRCLE
BEECH CREEK BLOCK

Section Number	Acreage N.F.	M. Feet B.M. for Species			LP	D	WF	WL	ES	W	Total	No. Diseased Trees	Cord Volume		Number of Snags, All Species					
		Yellow Pine											LP	WJ	12"-20"	22"-30"	32"-40"	42"+	Total	
		Mature	Immature	Total																
<u>T. 11 S., R. 32 E., W. M.</u>																				
30	132.00	130	80	210	1	89	58	7			365	15			70	10	19			99
31	446.98	2,974	856	3,830	10	801	952	685			6,278	730			693	746	247			1,686
32	104.00	435	159	594	5	46	107	107			859	63			71	109	86	10		276
Por Twp. Totals	682.98	3,539	1,095	4,634	16	936	1,117	799			7,502	808		48	834	865	352	10		2,061
<u>T. 12 S., R. 32 E., W. M.</u>																				
5	39.36	144	9	153	1	64	35	31			284	49	8		17		8			25
9	288.00	2,078	125	2,203		315	73	67			2,658	85		178	71	78	59			208
Por Twp. Totals	327.36	2,222	134	2,356	1	379	108	98			2,942	134	8	178	88	78	67			233
		Block Totals																		
	1,010.34	5,761	1,229	6,990	17	1,315	1,225	897			10,444	942	8	226	922	943	419	10		2,294
		Project Totals																		
4 Blocks	29,815.64	96,655	37,962	134,617	381	27,145	14,257	13,728	539	71	190,738	7,954	112	3,467	32,449	18,058	5,322	1,018		56,847

TABLE No. 12
SUMMARY OF NUMBER OF POLES
MIDDLE FORK JOHN DAY RIVER WORKING CIRCLE
CAMP CREEK BLOCK

Section Number	Western Yellow Pine						Lodgepole Pine	Douglas Fir		White Fir		Western Larch		Engelmann Spruce		Total All Species			
	Mature		Immature		Total			4"-7"	8"-11"	4"-7"	8"-11"	4"-7"	8"-11"	4"-7"	8"-11"	4"-7"	8"-11"	4"-7"	8"-11"
	4"-7"	8"-11"	4"-7"	8"-11"	4"-7"	8"-11"		4"-7"	8"-11"	4"-7"	8"-11"	4"-7"	8"-11"	4"-7"	8"-11"	4"-7"	8"-11"	4"-7"	8"-11"
COMPARTMENT NO. 1																			
T. 10 S., R. 32 E., W. M.																			
4	40	90	690	405	730	495	52		1,173	1,185	638	442	393	312			2,986	2,434	
8	40	60	56	28	96	88	492	60	397	264	2,987	1,204					3,972	1,616	
9	21	31	26		47	31	447	131	71	71	2,532	1,085	265	540			3,362	1,858	
Comp't 1 Totals	101	181	772	433	873	614	991	191	1,641	1,520	6,157	2,731	658	852			10,320	5,908	
COMPARTMENT NO. 2																			
T. 10 S., R. 32 E., W. M.																			
2			290	80	290	80			50	110			10				350	190	
3	72	43	425	142	497	185			1,952	861	483	192	281	271			3,213	1,509	
Comp't 2 Totals	72	43	715	222	787	265			2,002	971	483	192	291	271			3,563	1,699	
COMPARTMENT NO. 3																			
T. 10 S., R. 32 E., W. M.																			
3	10		110	100	120	100			20	30	20	20	10	20			170	170	
8	30		411	170	441	170			251	61	310	180	30	10			1,032	421	
9	20		58	50	78	50	581	49	182	79	430	204	392	155			1,663	537	
10	119	87	1,211	537	1,330	624			1,766	671	774	268	149	234			4,019	1,797	
15			160	210	160	210			360	170	120	100	50	10			690	490	
16	30	65	632	428	662	493	1,343	409	1,531	863	7,564	2,988	831	596			11,931	5,349	
17	31	31	155	174	186	205	298	40	429	641	1,592	1,222	421	273			2,926	2,383	
21	40		80	200	120	200	20	100	140	80	2,040	790	60	20			2,380	1,160	
Comp't 3 Totals	280	183	2,817	1,869	3,097	2,052	2,242	598	4,679	2,595	12,850	5,742	1,943	1,320			24,811	12,307	
COMPARTMENT NO. 4																			
T. 10 S., R. 32 E., W. M.																			
13		10	1,320	240	1,320	250											1,320	250	
14			1,410	210	1,410	210											1,410	210	
22			949	442	949	442	220	70	519	137	3,323	2,046	303	117			5,314	2,812	
23			2,747	163	2,747	163			478	156							3,225	319	
24	20	30	400	100	420	130			550	90							970	220	
26			940	230	940	230											940	230	
Comp't 4 Totals	20	40	7,766	1,385	7,786	1,425	220	70	1,547	383	3,323	2,046	303	117			13,179	4,041	
COMPARTMENT NO. 5																			
T. 10 S., R. 32 E., W. M.																			
22			114	195	114	195			133	9	19						266	204	
26			2,468	935	2,468	935			38	48				9			2,506	992	
27		10	6,080	2,606	6,080	2,616			724	661	190	70	20	10			7,014	3,347	
28			826	462	826	462			114		1,356	786	30	10			2,326	1,258	
34		8	280	102	280	110			8	17			8				296	127	
35		10	257	51	257	61			120	30							377	91	
Comp't 5 Totals		28	10,025	4,351	10,025	4,379			1,137	765	1,565	856	58	19			12,785	6,019	
COMPARTMENT NO. 6																			
T. 10 S., R. 32 E., W. M.																			
25		30	1,372	366	1,372	396			110	10			10	10			1,492	416	
36			745	466	745	466											745	466	
Comp't 6 Totals		30	2,117	832	2,117	862			110	10			10	10			2,237	882	
COMPARTMENT NO. 7																			
T. 10 S., R. 32 E., W. M.																			
36			2,575	3,050	2,575	3,050			210	364				40			2,785	3,454	
COMPARTMENT NO. 8																			
T. 11 S., R. 32 E., W. M.																			
1		19	798	745	798	764			304	494	95	115	145	143			1,342	1,516	
2	10	10		20	10	30			10	30	30						50	60	
Por. Twp. Totals	10	29	798	765	808	794			314	524	125	115	145	143			1,392	1,576	
Comp't 7 Totals	10	29	3,373	3,815	3,383	3,844			524	888	125	115	145	183			4,117	5,030	

TABLE No. 12 (Continued)
SUMMARY OF NUMBER OF POLES
MIDDLE FORK JOHN DAY RIVER WORKING CIRCLE
CAMP CREEK BLOCK

Section Number	Western Yellow Pine						Lodgepole Pine	Douglas Fir		White Fir		Western Larch		Engelmann Spruce		Total All Species			
	Mature		Immature		Total			4"-7"	8"-11"	4"-7"	8"-11"	4"-7"	8"-11"	4"-7"	8"-11"	4"-7"	8"-11"	4"-7"	8"-11"
	4"-7"	8"-11"	4"-7"	8"-11"	4"-7"	8"-11"		4"-7"	8"-11"	4"-7"	8"-11"	4"-7"	8"-11"	4"-7"	8"-11"	4"-7"	8"-11"	4"-7"	8"-11"
COMPARTMENT NO. 8																			
T. 10 S., R. 32 E., W. M.																			
35			178	52	178	52			188	63							366	146	
36			1,380	2,790	1,380	2,790			40	210							1,420	3,000	
Por. Twp. Totals			1,558	2,842	1,558	2,842			228	273							1,786	3,146	
T. 11 S., R. 32 E., W. M.																			
1			294	231	294	231											294	231	
2			2,220	2,105	2,220	2,105			1,195	1,050							3,491	3,235	
11	20	60	180	110	200	170			160	80		10	76	70			360	250	
Por. Twp. Totals	20	60	2,694	2,446	2,714	2,506			1,355	1,130		10	76	70			4,145	3,716	
Comp't 8 Totals	20	60	4,252	5,288	4,272	5,348			1,583	1,403		10	76	101			5,931	6,862	
COMPARTMENT NO. 9																			
T. 10 S., R. 32 E., W. M.																			
29		88	24	331	24	419	285	285	416	640							725	1,344	
30			242	450	242	450	210	630	715	1,115				210			1,167	2,405	
31		10	330	300	330	310			140	100	110	30	10				590	440	
32		19	1,104	804	1,104	823	977	450	444	332	1,776	779	329	597	235	290	4,865	3,271	
33		35	798	771	798	806	322	115	402	311	495	377	145	300			2,162	1,909	
34		21	2,301	2,489	2,301	2,510			416	654			10	135			2,727	3,299	
35		10	180	40	180	50			120	30							300	80	
Por. Twp. Totals		183	4,979	5,185	4,979	5,368	1,794	1,480	2,653	3,182	2,381	1,186	494	1,242	235	290	12,536	12,748	
T. 11 S., R. 32 E., W. M.																			
5			96	262	96	262	80	200	312	489				100			488	1,051	
Por. Twp. Totals			96	262	96	262	80	200	312	489				100			488	1,051	
Comp't 9 Totals		183	5,075	5,447	5,075	5,630	1,874	1,680	2,965	3,671	2,381	1,186	494	1,342	235	290	13,024	13,799	
COMPARTMENT NO. 10																			
T. 10 S., R. 32 E., W. M.																			
34		15	499	658	499	673											499	673	
T. 11 S., R. 32 E., W. M.																			
3	10	43	619	275	629	318			271	23	40	43	120	50			1,060	434	
4			2,210	3,366	2,210	3,366			1,542	2,094				340			3,752	5,800	
5			155	536	155	536				218							155	754	
Por Twp. Totals	10	43	2,984	4,177	2,994	4,220			1,813	2,335	40	43	120	390			4,967	6,988	
Comp't 10 Totals	10	58	3,483	4,835	3,493	4,893			1,813	2,335	40	43	120	390			5,466	7,661	
COMPARTMENT NO. 11																			
T. 11 S., R. 32 E., W. M.																			
3	20	60	620	390	640	450			210	60	20	20	70	10			940	540	
8	10	30	37	108	47	138	589	247	369	269	1,879	1,259	220	261			3,104	2,174	
9		20	2,063	610	2,063	630			405	265	187	44	25				2,680	939	
10			750	100	750	100											750	100	
16	9	30	897	988	906	1,018			713	466	872	816	176	183			2,667	2,483	
17		34	130	354	130	388			97	87	1,135	1,276	41	179			1,403	1,930	
18			73		73				106	304		27	386	893	18	108	510	1,405	
Comp't 11 Totals	39	174	4,497	2,623	4,536	2,797	589	247	1,900	1,451	4,093	3,442	918	1,526	18	108	12,054	9,571	

TABLE No. 12 (Cont'd)
SUMMARY OF NUMBER OF POLES
MIDDLE FORK JOHN DAY RIVER WORKING CIRCLE
CAMP CREEK BLOCK

Section Number	Western Yellow Pine						Lodgepole Pine		Douglas Fir		White Fir		Western larch		Engelmann Spruce		Total All Species	
	Mature		Immature		Total		4"-7"	8"-11"	4"-7"	8"-11"	4"-7"	8"-11"	4"-7"	8"-11"	4"-7"	8"-11"	4"-7"	8"-11"
	4"-7"	8"-11"	4"-7"	8"-11"	4"-7"	8"-11"												
T. 11 S. R. 32 E., W. M.																		
COMPARTMENT NO. 12																		
16	178	1,072	762	42	940	1,114	24		307	148	94	51	21	22			1,386	1,335
17			335		335			12	132		395	49					862	61
20			558	1,214	558	1,214	95	19	446	2,125				220			1,099	3,578
21		21	2,058	1,422	2,058	1,443			725	434	329	182	99	61			3,211	2,120
29			13	67	13	67	175	54	13	14		13					201	148
Comp't 12 Totals	178	1,093	3,726	2,745	3,904	3,838	294	85	1,623	2,721	8,188	295	120	303			6,759	7,242
T. 11 S. R. 32 E., W. M.																		
COMPARTMENT NO. 13																		
9			160	130	160	130			20	60	40	20					220	210
15			1,775	691	1,775	691			570	310	17		690	20			3,052	1,021
16	237	313	511	389	748	702		9	267	210	160	40	10	24			1,185	985
21	20	20	1,589	1,807	1,609	1,827			317	230	294	527	153	299			2,373	2,883
22	40	80	580	240	620	320			100	130	230	70	230	110			1,180	630
Comp't 13 Totals	297	413	4,615	3,257	4,912	3,670		9	1,274	940	741	657	1,083	453			8,010	5,729
T. 11 S. R. 32 E., W. M.																		
COMPARTMENT NO. 14																		
10	70	110	1,040	360	1,110	470			570	160	170	20	10	40			1,860	690
15	30	38	3,726	3,608	3,756	3,646			2,118	2,092	435	296	243	134			6,552	6,168
22		30	1,921	1,261	1,921	1,291	2,340	396	1,684	839	995	383	1,883	818			8,823	3,727
23	10	10	230	120	240	130	50		110	20	80	20					480	170
26			50	30	50	30	80	10	10	20	160	80	130	70			430	210
27			115	414	115	414	285	301	610	824	9	9		296			1,019	630
Comp't 14 Totals	110	188	7,082	5,793	7,192	5,981	2,755	707	5,102	3,955	1,849	808	2,266	1,358			19,164	12,809
T. 11 S. R. 32 E., W. M.																		
COMPARTMENT NO. 15																		
10			329	116	329	116			142	129	106	68	53	53			630	366
11	32	100	1,696	599	1,728	699			447	124	472	132	77	15			2,724	970
12	10	10	510	120	520	130			10	10							530	140
13		10	1,610	801	1,610	811			901	230	623	111	120	40			3,254	1,192
14	90	32	2,634	1,966	2,724	1,998			636	193	538	333	183	180			4,081	2,704
15			790	790	790	790			450	410	220	310	30				1,490	1,510
22			253	138	253	138			34	80		11					287	229
23	20	102	1,810	619	1,830	721	280	67	692	389	742	413	540	242			4,084	1,832
24			263	159	263	159	178	39	325	269	1,239	460	98	138	28		2,131	1,065
26		10	188	114	186	124	442	24	335	225	735	577	390	145			2,090	1,095
Comp't 15 Totals	152	264	10,083	5,422	10,235	5,686	900	130	3,972	2,059	4,675	2,415	1,491	813	28		21,301	11,103
T. 11 S. R. 32 E., W. M.																		
COMPARTMENT NO. 16																		
12	40	60	1,450	490	1,490	550			830	190	250	80	70	40			2,640	860
13			390	290	390	290			286	251	894	879	42	55			1,612	1,475
24			71	61	71	61	100	40	124	30	470	141	10	90			775	362
Comp't 16 Totals	40	60	1,911	841	1,951	901	100	40	1,240	471	1,614	1,100	122	185			5,027	2,697

TABLE No. 12 (Continued)
SUMMARY OF NUMBER OF POLES
MIDDLE FORK JOHN DAY RIVER WORKING CIRCLE
CAMP CREEK BLOCK

Section Number	Western Yellow Pine						Lodgepole Pine		Douglas Fir		White Fir		Western Larch		Engelmann Spruce		Total All Species	
	Mature		Immature		Total		4"-7"	8"-11"	4"-7"	8"-11"	4"-7"	8"-11"	4"-7"	8"-11"	4"-7"	8"-11"	4"-7"	8"-11"
	4"-7"	8"-11"	4"-7"	8"-11"	4"-7"	8"-11"												
COMPARTMENT NO. 17																		
T. 11 S. R. 32 E., W.M.																		
21			13	273	13	273						82					13	355
22	10	20	370	180	380	200			140	20	80	10					600	230
26	10	50	980	360	990	410	440	30	890	360	530	210	190	110			3,040	1,120
27			262	407	262	407			200	238			130	20			592	665
28	20	68	1,021	1,137	1,041	1,205	305	30	428	115	126	723	88	36			1,988	2,109
34			452	548	452	548	76	107	24	36			36	36			588	727
35		18	1,356	1,106	1,356	1,124	160	289	427	304	1,491	882	360	456			3,794	3,055
Comp't 17 Totals	40	156	4,454	4,011	4,494	4,167	981	456	2,109	1,073	2,227	1,907	804	658			10,615	8,261
COMPARTMENT NO. 18																		
T. 11 S. R. 32 E., W.M.																		
20				450		450				270								720
28	10	26	428	320	438	346	2,113	518	172	285	478	233	535	380			3,736	1,762
29		27	990	1,047	990	1,074	723	438	985	647	1,963	2,512	226	459			4,887	5,130
30	6	6	252	230	258	236	941	530	483	621	1,818	1,316		114	20		3,520	2,817
32			104	40	104	40	720	188	192	194	1,056	800	80	28			2,152	1,250
33			11		11		110	44	5	11			22				148	55
Comp't 18 Totals	16	59	1,785	2,087	1,601	2,146	4,607	1,718	1,837	2,028	5,315	4,861	863	981	20		14,443	11,734
COMPARTMENT NO. 19																		
T. 11 S. R. 32 E., W.M.																		
33			9	40	9	40	265	176	36	28		4	103	53			413	301
34			19	11	19	11	320	426	23	26			26	49			388	512
35							175	44					44	44			220	88
Por. Twp. Totals			28	51	28	51	761	646	59	54		4	173	145			1,021	901
COMPARTMENT NO. 20																		
T. 12 S. R. 32 E., W.M.																		
2		18	20	95	20	113	227	59	56	173	110	79	178	168			591	592
3			61	60	61	60	1,065	564	322	591	965	1,329	260	493	201	233	2,874	3,270
4		20	568	654	568	674	5,047	2,395	482	782	2,694	1,547	808	1,193			9,599	6,591
9		16	239	99	239	115	340	462	376	188	1,089	714	59	54			2,103	1,533
Por. Twp. Totals		54	888	908	888	962	6,679	3,480	1,236	1,734	4,858	3,669	1,305	1,908	201	233	15,167	11,986
Comp't 19 Totals		54	916	959	916	1,013	7,440	4,126	1,295	1,788	4,858	3,673	1,478	2,054	201	233	16,188	12,887
COMPARTMENT NO. 20																		
T. 11 S. R. 32 E., W.M.																		
35			349	379	349	379	85	85	68	57			17	17			519	538
COMPARTMENT NO. 21																		
T. 12 S. R. 32 E., W.M.																		
2		30	523	324	523	354	2,512	1,093	462	373	1,586	757	780	704			5,863	3,281
Comp't 20 Totals		30	872	703	872	733	2,597	1,178	530	430	1,586	757	797	721			6,382	3,819
Block Totals																		
	1,385	3,326	80,336	56,918	81,721	60,244	25,590	11,235	38,883	31,457	54,700	32,836	14,040	13,657	502	631	215,436	150,060

TABLE No. 13
SUMMARY OF NUMBER OF POLES
MIDDLE FORK JOHN DAY RIVER WORKING CIRCLE
SLIDE CREEK BLOCK

Section Number	Western Yellow Pine						Lodgepole Pine		Douglas Fir		White Fir		Western Larch		Engelmann Spruce		Total All Species	
	Mature		Immature		Total		4"-7"	8"-11"	4"-7"	8"-11"	4"-7"	8"-11"	4"-7"	8"-11"	4"-7"	8"-11"	4"-7"	8"-11"
	4"-7"	8"-11"	4"-7"	8"-11"	4"-7"	8"-11"												
COMPARTMENT NO. 1																		
T. 9 S., R. 31 E., W. M.																		
21			1,008	460	1,008	460			2,250	615	2,163	1,108	170	84			5,591	2,267
COMPARTMENT NO. 2																		
T. 9 S., R. 31 E., W. M.																		
21									80	30							80	30
22			4,674	1,178	4,674	1,178	11		1,433	936	961	376	450	127			7,529	2,617
27			2,318	1,552	2,318	1,552			2,799	1,373	999	385	94	78			6,210	3,388
28			100	90	100	90											100	90
Comp't 2 Totals			7,092	2,820	7,092	2,820	11		4,312	2,339	1,960	761	544	205			13,919	6,125
COMPARTMENT NO. 3																		
T. 9 S., R. 31 E., W. M.																		
27			1,498	359	1,498	359			365	145							1,863	504
33			2,484	891	2,484	891			628	307							3,112	1,198
34	40	10	9,412	3,956	9,452	3,966			3,012	1,476	79	71					12,543	5,513
Por. Twp. Totals	40	10	13,394	5,206	13,434	5,216			4,005	1,928	79	71					17,518	7,215
COMPARTMENT NO. 4																		
T. 10 S., R. 31 E., W. M.																		
3		21	822	816	843	878			865	643	626	831		19			2,334	2,371
4			1,105	720	1,105	720			624	542	291	262	11	22			2,031	1,546
Por. Twp. Totals	21	62	1,927	1,536	1,948	1,598			1,489	1,185	917	1,093	11	41			4,365	3,917
Comp't 3 Totals	61	72	15,321	6,742	15,382	6,184			5,494	3,113	996	1,164	11	41			21,883	11,132
COMPARTMENT NO. 4																		
T. 10 S., R. 31 E., W. M.																		
3			2,380	1,104	2,380	1,104			741	338	1,141	440	128	170			4,390	2,052
4			195	118	195	118			123	27	154	101		8			472	254
9		6	39	45	39	51			13	13	78	32					130	96
10	10	10	306	375	316	385			639	601	516	701	275	208			1,746	1,895
11			1,185	902	1,185	902				21							1,185	923
15																		
Comp't 4 Totals	10	16	4,105	2,544	4,115	2,560			1,516	1,000	1,889	1,274	403	386			7,923	5,220
COMPARTMENT NO. 5																		
T. 10 S., R. 31 E., W. M.																		
10	50	100	10	30	60	130					10	10		10			70	150
11	11	11	897	915	908	926							28	47			936	973
13		9	715	509	715	518			146	184	258	184	28	56			1,147	942
14		10	1,242	1,348	1,242	1,358			181	288	145	154	18	27			1,586	1,827
15		10	399	430	399	440			266	210	170	127					835	777
23			155	117	155	117					106	26					261	143
24	70	34	266	401	336	435			535	402	396	255	254	514			1,531	1,606
Por. Twp. Totals	131	174	3,684	3,750	3,815	3,924			1,128	1,084	1,085	756	338	654			6,366	6,418
COMPARTMENT NO. 5																		
T. 10 S., R. 32 E., W. M.																		
19		33	154	327	154	360	1,813	1,904	435	622			198	798			2,600	3,682
Comp't 5 Totals	131	207	3,838	4,077	3,969	4,284	1,813	1,904	1,563	1,706	1,085	756	536	1,450			8,966	10,100

TABLE No.13 (Cont'd)
SUMMARY OF NUMBER OF POLES
MIDDLE FORK JOHN DAY RIVER WORKING CIRCLE
SLIDE CREEK BLOCK

Section Number	Western Yellow Pine						Lodgepole Pine	Douglas Fir	White Fir	Western Larch	Engelmann Spruce		Total All Species						
	Mature		Immature		Total						4"-7"	8"-11"	4"-7"	8"-11"	4"-7"	8"-11"	4"-7"	8"-11"	
	4"-7"	8"-11"	4"-7"	8"-11"	4"-7"	8"-11"													
COMPARTMENT NO. 6																			
T. 10 S., R. 31 E., W. M.																			
11		10	42	75	42	85		88	75	31	94							161	254
12																			
13	60	30	905	465	965	495		641	570	881	729	210	177					2,697	1,971
14				30		30		10	10	20	10							30	50
Por. Twp. Totals	60	40	947	570	1,007	610		739	655	932	833	210	177					2,888	2,275
COMPARTMENT NO. 7																			
T. 10 S., R. 32 E., W. M.																			
17	38	10	239	158	277	168	565	682	625	303	262	78	279	112				2,008	1,343
18	50		632	640	682	640	379	233	256	233	211	94	159	79	31	20		1,718	1,299
19		23	18	155	18	178	148	436	74	588				91				240	1,293
Por. Twp. Totals	88	33	889	953	997	986	1,092	1,351	955	1,124	473	172	438	282	31	20		3,966	3,935
Comp't 6 Totals	148	73	1,836	1,523	1,984	1,596	1,092	1,351	1,694	1,779	1,405	1,005	648	459	31	20		6,854	6,210
COMPARTMENT NO. 8																			
T. 10 S., R. 31 E., W. M.																			
11			924	762	924	762			10	50	60							984	832
12			1,537	1,124	1,537	1,124			433	63	402	258	20					2,392	1,445
13	66	36	394	144	460	180			948	258	66	19		9				1,474	466
Por. Twp. Totals	66	36	2,855	2,030	2,921	2,066			1,391	331	518	337	20	9				4,850	2,743
COMPARTMENT NO. 8																			
T. 10 S., R. 32 E., W. M.																			
7	258	131	1,507	876	1,765	1,007	244	24	224	65	366	101	142	52				2,741	1,249
18	173	71	269	633	442	704	361	182	1,034	549	1,434	959	485	389	300	321		4,056	3,104
Por. Twp. Totals	431	202	1,776	1,509	2,207	1,711	605	206	1,258	614	1,800	1,060	627	441	300	321		6,797	4,353
Comp't 7 Totals	497	238	4,631	3,359	5,128	3,777	605	206	2,649	945	2,318	1,397	647	450	300	321		11,647	7,096
COMPARTMENT NO. 8																			
T. 10 S., R. 32 E., W. M.																			
6	12	83	588	82	600	165			703	86	447	186	130	132				1,880	569
7	10	11	378	31	388	42			554	202	550	444	173	160				1,665	848
8	10		50	70	60	70	403	79	336	171	1,324	363	110	104				2,233	787
Comp't 8 Totals	32	94	1,016	183	1,048	277	403	79	1,593	459	2,321	993	413	396				5,778	2,204
Block Totals																			
8 Compartments	879	700	38,847	21,888	39,726	22,598	3,924	3,540	21,071	11,956	14,137	8,458	3,372	3,471	331	341		82,561	50,354

TABLE No. 14
SUMMARY OF NUMBER OF POLES
MIDDLE FORK JOHN DAY RIVER WORKING CIRCLE
LONG CREEK BLOCK

Section Number	Western Yellow Pine						Lodgepole Pine		Douglas Fir		White Fir		Western Larch		Engelmann Spruce		Total All Species		
	Mature		Immature		Total		4"-7"	8"-11"	4"-7"	8"-11"	4"-7"	8"-11"	4"-7"	8"-11"	4"-7"	8"-11"	4"-7"	8"-11"	
	4"-7"	8"-11"	4"-7"	8"-11"	4"-7"	8"-11"													
T. 9 S., R. 31 E., W. M.																			
21			284	92	284	92												284	92
28			926	466	926	466			1,198	599	4,021	2,105	64	16				6,209	3,186
33			1,735	583	1,735	583			1,208	391	1,615	823	75	26				4,633	1,823
Por. Twp. Totals			2,945	1,141	2,945	1,141			2,406	990	5,636	2,928	139	42				11,126	5,101
T. 10 S., R. 31 E., W. M.																			
4			278	307	278	307			24	64	101	143						403	514
9			518	593	518	593			613	240	1,565	1,001	158	45	9	9		2,863	1,888
10																			
Por Twp. Totals			796	900	796	900			637	304	1,666	1,144	158	45	9	9		3,266	2,402
T. 10 S., R. 32 E., W. M.																			
19								333	92	333								92	666
30		9	420	1,022	420	1,031		189	527	1,037				84				947	2,341
31		35	326	380	326	415	658	313	1,099	1,231	2,014	867	149	298				4,246	3,124
Por. Twp. Totals		44	746	1,402	746	1,446	658	835	1,718	2,601	2,014	867	149	382				5,285	6,131
T. 11 S., R. 32 E., W. M.																			
7		15	581	1,073	581	1,088	3,135	1,877	4,033	6,801	1,331	2,336	496	1,551				9,576	13,653
8							855	249	124	151	1,123	615	59	135				2,161	1,150
18			115	437	115	437			230	1,010								345	1,447
19			62	725	62	725	4,122	4,801	1,677	3,100			196	1,067				6,057	9,693
Por. Twp. Totals		15	758	2,235	758	2,250	8,112	6,927	6,064	11,062	2,454	2,951	751	2,753				18,139	25,943
Block Totals																			
		59	5,245	5,678	5,245	5,737	8,770	7,762	10,825	14,957	11,770	7,890	1,197	3,222	9	9		37,816	39,577

TABLE No. 15
SUMMARY OF NUMBER OF POLES
MIDDLE FORK JOHN DAY RIVER WORKING CIRCLE
BEECH CREEK BLOCK

Section Number	Western Yellow Pine						Lodgepole Pine	Douglas Fir	White Fir	Western Larch	Engelmann Spruce		Total All Species					
	Mature		Immature		Total						4"-7"	8"-11"	4"-7"	8"-11"	4"-7"	8"-11"	4"-7"	8"-11"
	4"-7"	8"-11"	4"-7"	8"-11"	4"-7"	8"-11"												
T. 11 S., R. 32 E., W. M.																		
30				18		18	55	54	45	45	4,097	1,975	323	460	397	677	4,917	3,229
31		43	599	752	599	795	3,700	1,418	898	759	3,393	3,429	749	735			9,339	7,136
32		10	402	201	402	211	1,495	299	168	170	1,745	656	128	136			3,938	1,472
Por. Twp. Totals		53	1,001	971	1,001	1,024	5,250	1,771	1,111	974	9,235	6,060	1,200	1,331	397	677	18,194	11,837
T. 12 S., R. 32 E., W. M.																		
5			34	149	34	149	227	47	197	231	191	108	91	42			740	577
9		167	1,609	749	1,609	916	32	21	231	181	296	226	53	85			2,221	1,429
Por. Twp. Totals		167	1,643	898	1,643	1,065	259	68	428	412	487	334	144	127			2,961	2,006
							Block Totals											
		220	2,644	1,869	2,644	2,089	5,509	1,839	1,539	1,386	9,722	6,394	1,344	1,458	397	677	21,155	13,843
							Project Totals											
4 Blocks	2,264	4,305	127,072	86,353	129,336	90,658	43,793	24,376	72,318	59,756	90,329	55,578	19,953	21,808	1,239	1,658	356,968	253,834