

United States Department of Agriculture  
Forest Service  
South Dakota  
2019  
America's Great Outdoors  
National Grassland  
Fort Pierre  
Motor Vehicle  
Use Map

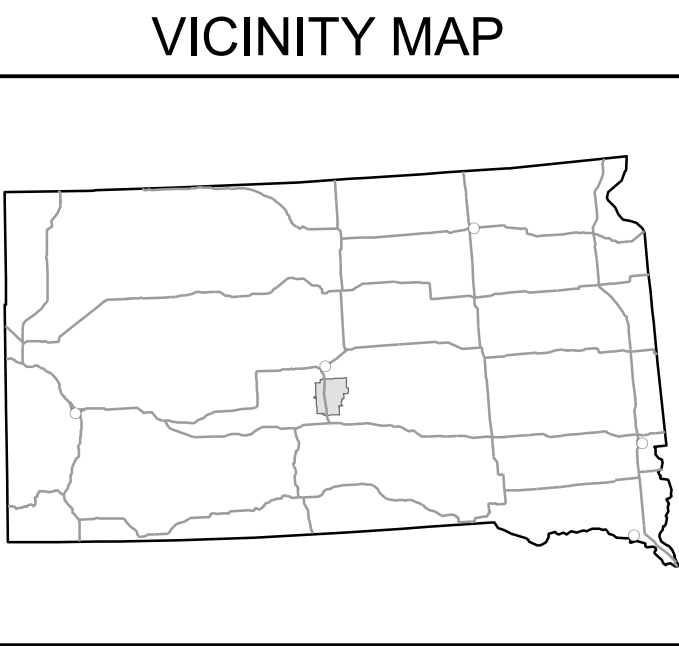

**INFORMATION SOURCES**

In the event of an emergency call 911

USFS Contacts:  
Fort Pierre National Grassland  
1020 N Deadwood Street  
Fort Pierre, SD 57532  
Office: (605) 224-5517 Fax: (605) 224-6517

Visit The Fort Pierre National Grassland website at:  
[http://www.fs.fed.us/2/nebraska/recreation/by\\_unit/fpnp.shtml](http://www.fs.fed.us/2/nebraska/recreation/by_unit/fpnp.shtml)

Nebraska National Forests & Grasslands  
125 North Main Street  
Chadron, NE 69337  
Office Phone: 308-432-0300  
Fax: 308-432-0309

Visit The Nebraska National Forests & Grasslands website at:  
<http://www.fs.fed.us/2/nebraska/>

South Dakota Game, Fish & Parks  
[www.sdgame.com](http://www.sdgame.com)  
(605) 773-3393

The U.S. Department of Agriculture (USDA) prohibits discrimination in all its programs and activities on the basis of race, color, national origin, age, disability, and where applicable, sex, marital status, familial status, parental status, religion, sexual orientation, genetic information, political beliefs, reprisal, or because all or part of an individual's income is derived from any public assistance program. (Not all prohibited bases apply to all programs.) Persons with disabilities who require alternative means for communication of program information (Braille, large print, audiotape, etc.) should contact USDA's TARGET Center at (202) 720-2600 (voice and TDD). To file a complaint of discrimination, write to USDA, Director, Office of Civil Rights, 1400 Independence Avenue, S.W., Washington, D.C. 20250-9410, or call (800) 795-3272 (voice) or (202) 720-6382 (TDD). USDA is an equal opportunity provider and employer.

**PURPOSE AND CONTENTS OF THIS MAP**

The designations shown on this motor vehicle use map (MVUM) were made by the responsible official pursuant to 36 CFR 212.51; are effective as of the date on the front cover of this MVUM; and will remain in effect until superceded by the next year's MVUM.

It is the responsibility of the user to acquire the current MVUM. This MVUM shows the National Forest System roads, National Forest System trails, and the areas on National Forest System lands in the Fort Pierre National Grasslands that are designated for motor vehicle use pursuant to 36 CFR 212.51. This MVUM also identifies the vehicles classes allowed on each route and in each area and any seasonal restrictions that apply on those routes and in those areas.

Designation of a road, trail, or area for motor vehicle use by a particular class of vehicle under 36 CFR 212.51 should not be interpreted as encouraging or inviting use, or to imply that the road, trail, or area is passable, actively maintained, or safe for travel. Motor vehicle designations include parking along designated routes and at facilities associated with designated routes when it is safe to do so and when not causing damage to National Forest System resources. Seasonal weather conditions and natural events may render designated roads and trails impassable for extended periods. Designated areas may contain dangerous or impassable terrain. Many designated roads and trails may be passable only by high-clearance vehicles or four-wheel drive vehicles. Maintenance of designated roads and trails will depend on available resources, and many may require little maintenance.

This motor vehicle use map identifies those roads, trails, and areas designated for the motor vehicle use under 36 CFR 212.51 for the purpose of enforcing the prohibition at 36 CFR 261.13. This is a limited purpose. The other public roads are shown for information and navigation purposes only and are not subject to designation under the Forest Service travel management regulation.

**These designations apply only to National Forest System roads, National Forest System trails, and areas on National Forest System lands.**

**PROHIBITIONS**

**It is prohibited to possess or operate a motor vehicle on National Forest System lands on the Fort Pierre National Grassland other than in accordance with these designations (36 CFR 261.13).**

Violators of 36 CFR 261.13 are subject to a fine of up to \$5,000 or imprisonment for up to 6 months or both (18 U.S.C. 3571(e)). This prohibition applies regardless of the presence or absence of signs.

This map does not display nonmotorized uses, over-snow uses, or other facilities and attractions on the Fort Pierre National Grassland. Obtain forest visitor information from the local national forest office.

Designated roads, trails, and areas may also be subject to temporary, emergency closures. As a visitor, you must comply with signs notifying you of such restrictions. A national forest may issue an order to close a road, trail, or area on a temporary basis to protect the life, health or safety of forest visitors or the natural or cultural resources in these areas. Such a temporary and/or emergency closures are consistent with the Travel Management Rule (36 CFR 212.52 (b); 36 CFR 261 subpart B).

The designation "road or trail open to all motor vehicles" does not supersede State traffic law.

**OPERATOR RESPONSIBILITIES**

Operating a motor vehicle on National Forest System roads, National Forest System trails, and in areas on National Forest System lands carries a greater responsibility than operating that vehicle in a city or other developed setting. Not only must you know and follow all applicable traffic laws, you need to show concern for the environment as well as other forest users. The misuse of motor vehicles can lead to the temporary or permanent closure of any designated road, trail, or area. As a motor vehicle operator, you are subject to State traffic law, including State requirements for licensing, registration, and operation of the vehicle in question.

Motor vehicle use, especially off-highway vehicle use, involves inherent risks that may cause property damage, serious injury, and possibly death to participants. Drive cautiously and anticipate rough surfaces and features, such as snow, mud, vegetation, and water crossings common to remote driving conditions. By your participation, you voluntarily assume full responsibility for these damages, risks, and dangers. Take care at all times to protect yourself and those under your responsibility.

Much of the Fort Pierre National Grassland is remote. Medical assistance may not be readily available. Cellular telephones do not work in many areas of the Fort Pierre National Grassland. Take adequate food, water, first-aid supplies, and other equipment appropriate for the conditions.

**ALWAYS REMEMBER TO RESPECT PRIVATE LAND! PROTECT YOUR PRIVILEGE. STAY ON DESIGNATED ROADS AND TRAILS AND IN DESIGNATED AREAS.**

Read and understand this map in its entirety. If you have questions please contact the Fort Pierre National Grassland for clarification.

As a motor vehicle operator on a National Forest System road, trail, or area, you must comply with this map, as well as all Federal, State, and local laws and regulations.

Route Number	Legend	Special Vehicle Designation	Dates Allowed
200B-A, 202-A, 206-A, 215-B, 215-C, 217-B, 221, 224-A, 226-A, 231, 236, 236-A, 241, 243, 244, 251-A, 252-A, 254	Roads open to highway legal vehicles only, with Seasonal Designation	Seasonal Designation	12/01-08/31
207-A, 217-A, 222-A, 245, 248, 255	Roads open to highway legal vehicles only, with Seasonal Designation	Seasonal Designation	06/15-08/31

**Legend**

- Roads Open to Highway Legal Vehicles
- Seasonal Designation (See Table)
- Interstate
- Highways, US, State
- Other Public Roads
- 70333 Short Route Identifier
- Forest or Unit Boundary
- National Forest System Lands
- Non-National Forest System Lands within the National Forest
- Lakes and Rivers

**EXPLANATION OF LEGEND ITEMS**

**Roads Open to Highway Legal Vehicles Only:**

These roads are open only to motor vehicles licensed under State law for general operation on all public roads within the State.

**Seasonal Designation:**

This symbol, used in conjunction with one of the other road or trail symbols, indicates that the road or trail is open only during certain portions of the year. Refer to Seasonal and Special Designation Table for further instructions.

**Other Public Roads and Trails:**

- Interstate
- Highways, U.S., State
- Other Public Roads
- Other Public Trails

These symbols are used to show routes that the Forest Service does have not jurisdiction over and has not designated for motorized use. These symbols are part of the reference layers showing connections to towns and cities outside the forest boundary.

**Short Route Identifier:**

This symbol is used for roads that are too short to show a symbol type on the map. The symbol contains the road or trail number. Users should refer to the corresponding number in the Short Route Table for more information on the designated route.

**Roads Too Short to be Seen Clearly on the Map**

Road Number	Route Designation	Length in Feet
208-A	Routes Open to Highway Legal Vehicles Only	324

**treadlightly!**  
LEAVING A GOOD IMPRESSION

Travel and recreate with minimum impact.

Respect the environment and the rights of others.

Educate yourself plan and prepare before you go.

**BLANKET STATEMENTS FOR TRAVEL MANAGEMENT**

Motorized travel for dispersed camping is allowed within the vehicle use areas adjacent to the Sheriff Dam, Richland Dam and Richland Wildlife areas (208-A).

The FPNG complies with National Policy which welcomes wheelchairs or other exempt vehicles on all NFS lands open to foot travel. Exempt vehicles are defined as "any wheelchair or mobility device, including one that is battery-powered, that is designed solely for use by a mobility-impaired person for locomotion, and that is suitable for use in an indoor pedestrian area" (36 CFR Part 212). Otherwise there are no special provisions allowing motorized access for mobility-impaired persons off of the designated road system.

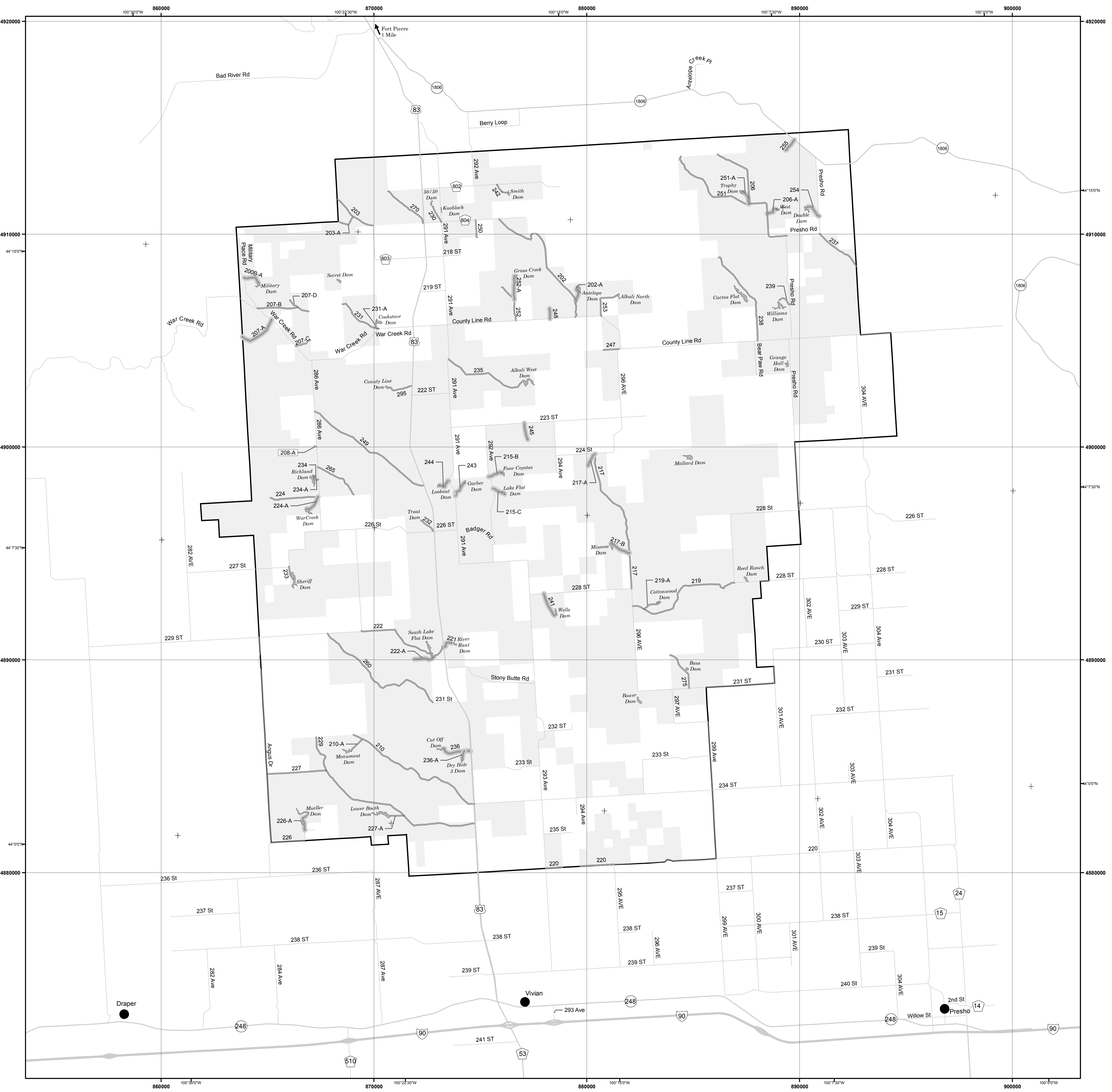

North American Datum of 1983 (NAD 83)  
Universal Transverse Mercator, zone 13