

Motor Vehicle Use Map

Comanche National Grassland

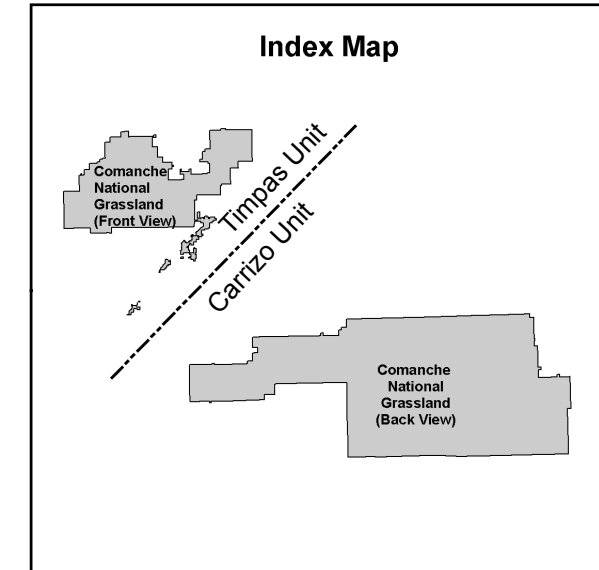
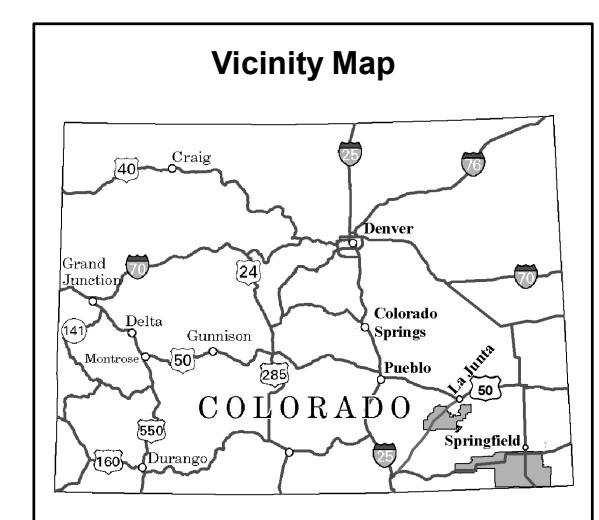

In accordance with Federal civil rights law and U.S. Department of Agriculture (USDA) civil rights regulations and policies, the USDA, its Agencies, offices, and employees, and institutions participating in or administering USDA programs are prohibited from discriminating based on race, color, national origin, religion, sex, gender identity (including gender expression), sexual orientation, disability, age, marital status, family/parental status, income derived from a public assistance program, political beliefs, or reprisal or retaliation for prior civil rights activity, in any program or activity conducted or funded by USDA (not all bases apply to all programs). Remedies and complaint filing deadlines vary by program or incident.

Persons with disabilities who require alternative means of communication for program information (e.g., Braille, large print, audiotape, American Sign Language, etc.) should contact the responsible Agency or USDA's TARGET Center at (202) 720-2600 (voice and TTY) or contact USDA through the Federal Relay Service at (800) 877-8339. Additionally, program information may be made available in languages other than English.

To file a program discrimination complaint, complete the USDA Program Discrimination Complaint Form, AD-3027, found online at http://www.ascr.usda.gov/complaint_filing_cust.html and at any USDA office or write a letter addressed to USDA and provide in the letter all of the information requested in the form. To request a copy of the complaint form, call (866) 632-6992. Submit your completed form or letter to USDA by: (1) mail: U.S. Department of Agriculture, Office of the Assistant Secretary for Civil Rights, 1400 Independence Avenue, SW, Washington, D.C. 20250-9410; (2) fax: (202) 690-7442; or (3) email: program.intake@usda.gov.

USDA is an equal opportunity provider, employer, and lender.

PURPOSE AND CONTENTS OF THIS MAP

The designations shown on this motor vehicle use map (MVUM) were made by the responsible official pursuant to 36 CFR 212.51, are effective as of the date on the front cover of this MVUM, and will remain in effect until superseded by next year's MVUM.

JOHN LINN
Digitally signed by JOHN LINN
DN: cn=JOHN LINN, o=USDA, ou=USDA, email=jlinn@fs.fed.us

Comanche District Ranger, Comanche National Grassland

It is the responsibility of the user to acquire the current MVUM. This MVUM shows the National Forest System roads, National Forest System trails, and the areas on National Forest System lands in the Comanche National Grassland that are designated for motor vehicle use pursuant to 36 CFR 212.51. This MVUM also identifies the vehicle classes allowed on each route and in each area; and any seasonal restrictions that apply on those routes and in those areas.

Designation of a road, trail, or area for motor vehicle use by a particular class of vehicle under 36 CFR 212.51 should not be interpreted as encouraging or inviting use, or to imply that the road, trail or area is passable, actively maintained, or safe for travel. Motor vehicle designations include parking along designated routes and at facilities associated with designated routes when it is safe to do so and when not causing damage to National Forest System resources. Seasonal weather conditions and natural events may render designated routes and trails impassable for extended periods. Designated areas may contain dangerous or impassable terrain. Many designated roads and trails may be passable only by high-clearance vehicles or four-wheel drive vehicles. Maintenance of designated roads and trails will depend on available resources, and many may receive little maintenance.

This motor vehicle use map identifies those roads, trails, and areas designated for motor vehicle use under 36 CFR 212.51 for the purpose of enforcing the prohibition at 36 CFR 261.13. This is a limited purpose. The other public roads are shown for information and navigation purposes only and are not subject to designation under the Forest Service travel management regulation.

These designations apply only to National Forest System roads, National Forest System trails, and areas on National Forest System lands.

LEGEND

- Roads Open to All Vehicles
- Interstate Highways, US, State, County & Other Public Roads
- U.S. Highway Route Symbol
- State Highway Route Symbol
- County Road Number
- Short Route Identifier (See Short Route Table)
- FS Picnic Area
- Cities, Towns
- Forest or Unit Boundary
- National Forest System Lands
- Non-National Forest System Lands within the National Forest
- County Boundary
- Township and Range Lines
- Section Lines
- Lakes and Rivers

0 1 2 3 Miles

OPERATOR RESPONSIBILITIES

Operating a motor vehicle on National Forest System roads, National Forest System trails, and in areas on National Forest System lands carries a greater responsibility than operating that vehicle in a city or other developed setting. Not only must you know and follow all applicable traffic laws, you need to show concern for the environment as well as other forest users. The misuse of motor vehicles can lead to the temporary or permanent closure of any designated road, trail, or area. As a motor vehicle operator, you are also subject to State traffic law, including State requirements for licensing, registration, and operation of the vehicle in question.

Motor vehicle use, especially off-highway vehicle use, involves inherent risks that may cause property damage, serious injury, and possibly death to participants. Drive cautiously and anticipate rough surfaces and features, such as snow, mud, vegetation, and water crossings common to remote driving conditions. By your participation, you voluntarily assume full responsibility for these damages, risks, and dangers. Take care at all times to protect yourself and those under your responsibility.

Much of the Comanche National Grassland is remote, and medical assistance may not be readily available. Cellular telephones do not work in many areas of the Comanche National Grassland. Take adequate food, water, first aid supplies, and other equipment appropriate for the conditions and expected weather.

ALWAYS REMEMBER TO RESPECT PRIVATE LAND! PROTECT YOUR PRIVILEGE. STAY ON DESIGNATED ROADS AND TRAILS AND IN DESIGNATED AREAS.

Read and understand this map in it's entirety. If you have questions, please contact the Comanche National Grassland for clarification.

As a motor vehicle operator on a National Forest System road, trail, or area you must comply with the MVUM, as well as all Federal, State, and local laws and regulations. Compliance with these rules is your responsibility.

EXPLANATION OF LEGEND ITEMS

Roads Open to All Vehicles:
Roads open to all motor vehicles, including smaller off highway vehicles that may not be licensed for highway use (not to oversize or overweight vehicles under State traffic law).

Highways:
— U.S. State, County, Other

Used to show routes not designated for motorized use by the Forest Service. Part of the reference layers showing connections to towns and cities outside the forest boundary.

Short Route Identifier:
[Symbol]

This symbol is used for routes that are too short to show a symbol type on the map. The symbol contains the number of the road or trail. Users should refer to the corresponding number in the Short Route Table for designation information.

INFORMATION SOURCES

Comanche National Grassland

Carrizo Unit
27204 HWY 287
Springfield, CO 81073
(719) 523-6591

Timpas Unit
1420 E. Third St.
La Junta, CO 81050
(719) 384-2181

Forest Supervisor
Pike and San Isabel National Forests
Cimarron and Comanche National Grasslands
2840 Kachina Drive
Pueblo, CO 81008
(719) 553-1400

In case of Emergency: Dial 911

Comanche National Grassland Website:
www.fs.usda.gov/goto/psicc/com

BLANKET STATEMENTS FOR TRAVEL MANAGEMENT

The designations shown on this map will remain in effect until revised with the publication of a new map. In January of each year, this motor vehicle use map will either be revised with the publication of a new map, or it will be validated for the new year by the Ranger District with a red stamp that says: "Valid for Year 20__".

Parking/ Dispersed Camping on the Comanche National Grassland:

- Where designated parking areas are not available, and where not specifically prohibited, unsafe, or causing resource damage, parking on National Forest System lands within one vehicle length off of designated routes is authorized.
- Dispersed camping is authorized on National Forest System lands except in specially designated areas that are closed to camping.
- MotORIZED dispersed camping is authorized within one vehicle length off of designated National Forest System routes, where not specifically prohibited, unsafe, or causing resource damage.
- Check with the local National Grassland District office for current information on areas closed to camping and for other travel management information.

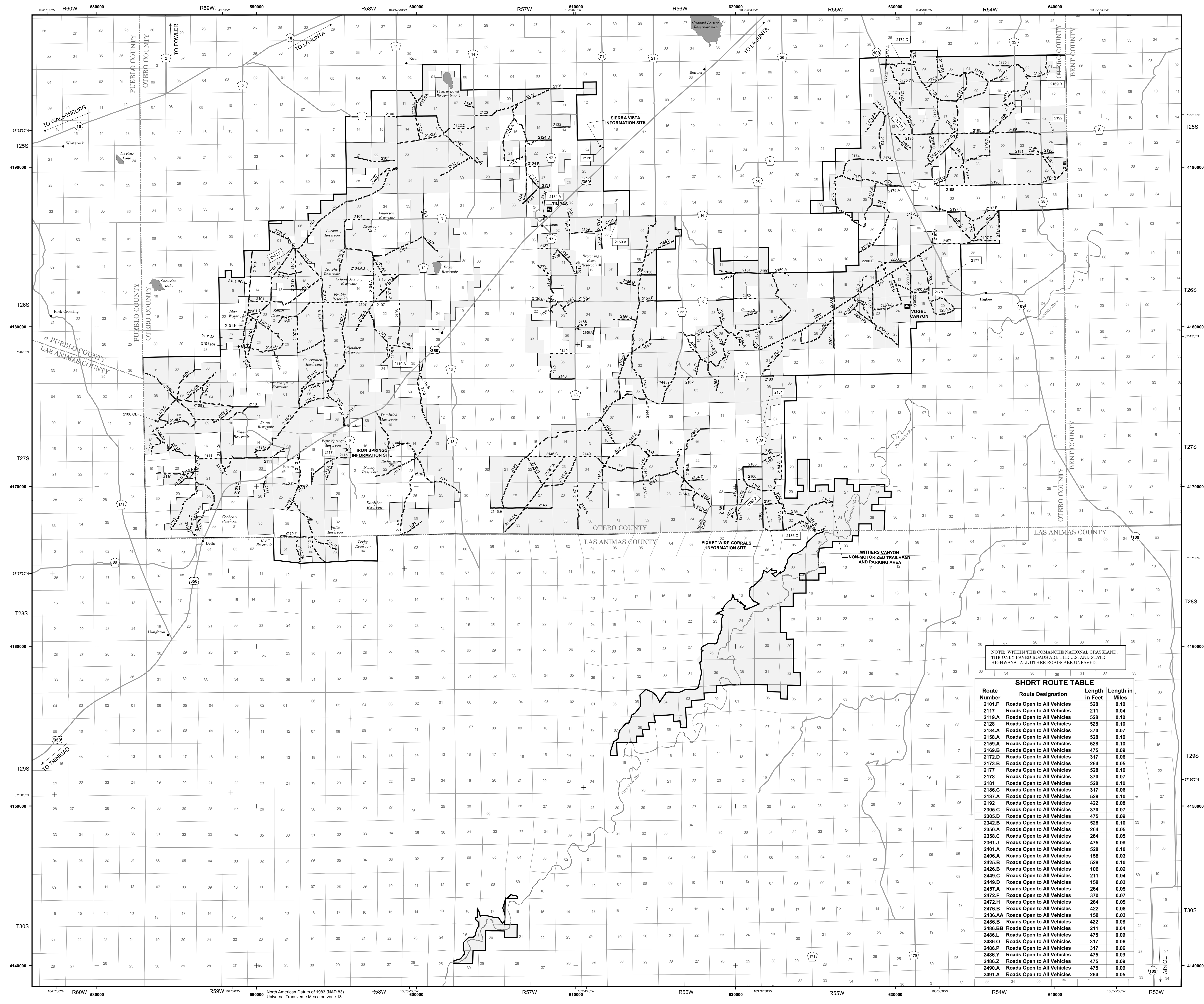

SHORT ROUTE TABLE

Route Number	Route Designation	Length in Feet	Length in Miles
2101.F	Roads Open to All Vehicles	528	0.10
2117	Roads Open to All Vehicles	211	0.04
2119.A	Roads Open to All Vehicles	528	0.10
2128	Roads Open to All Vehicles	528	0.10
2172.A	Roads Open to All Vehicles	370	0.07
2172.B	Roads Open to All Vehicles	284	0.05
2158.A	Roads Open to All Vehicles	528	0.10
2159.A	Roads Open to All Vehicles	528	0.10
2169.B	Roads Open to All Vehicles	475	0.09
2172.D	Roads Open to All Vehicles	317	0.06
2186.C	Roads Open to All Vehicles	317	0.06
2187.A	Roads Open to All Vehicles	528	0.10
2192	Roads Open to All Vehicles	422	0.08
2305.C	Roads Open to All Vehicles	370	0.07
2305.D	Roads Open to All Vehicles	274	0.05
2342.B	Roads Open to All Vehicles	264	0.05
2350.A	Roads Open to All Vehicles	264	0.05
2358.C	Roads Open to All Vehicles	264	0.05
2361.J	Roads Open to All Vehicles	475	0.09
2401.A	Roads Open to All Vehicles	528	0.10
2406.A	Roads Open to All Vehicles	158	0.03
2425.B	Roads Open to All Vehicles	528	0.10
2426.B	Roads Open to All Vehicles	106	0.02
2449.C	Roads Open to All Vehicles	211	0.04
2449.D	Roads Open to All Vehicles	158	0.03
2457.A	Roads Open to All Vehicles	264	0.05
2472.F	Roads Open to All Vehicles	370	0.07
2472.H	Roads Open to All Vehicles	264	0.05
2475.B	Roads Open to All Vehicles	422	0.08
2486.AA	Roads Open to All Vehicles	158	0.03
2486.B	Roads Open to All Vehicles	422	0.08
2486.BB	Roads Open to All Vehicles	211	0.04
2486.L	Roads Open to All Vehicles	475	0.09
2486.O	Roads Open to All Vehicles	317	0.06
2486.P	Roads Open to All Vehicles	317	0.06
2486.Y	Roads Open to All Vehicles	475	0.09
2486.Z	Roads Open to All Vehicles	475	0.09
2491.A	Roads Open to All Vehicles	264	0.05
2491.A	Roads Open to All Vehicles	264	0.05

NOTE: WITHIN THE COMANCHE NATIONAL GRASSLAND, THE ONLY PAVED ROADS ARE THE U.S. AND STATE HIGHWAYS. ALL OTHER ROADS ARE UNPAVED.