

Boundary Dam Timber Settlement Sullivan Lake Ranger District, Colville National Forest

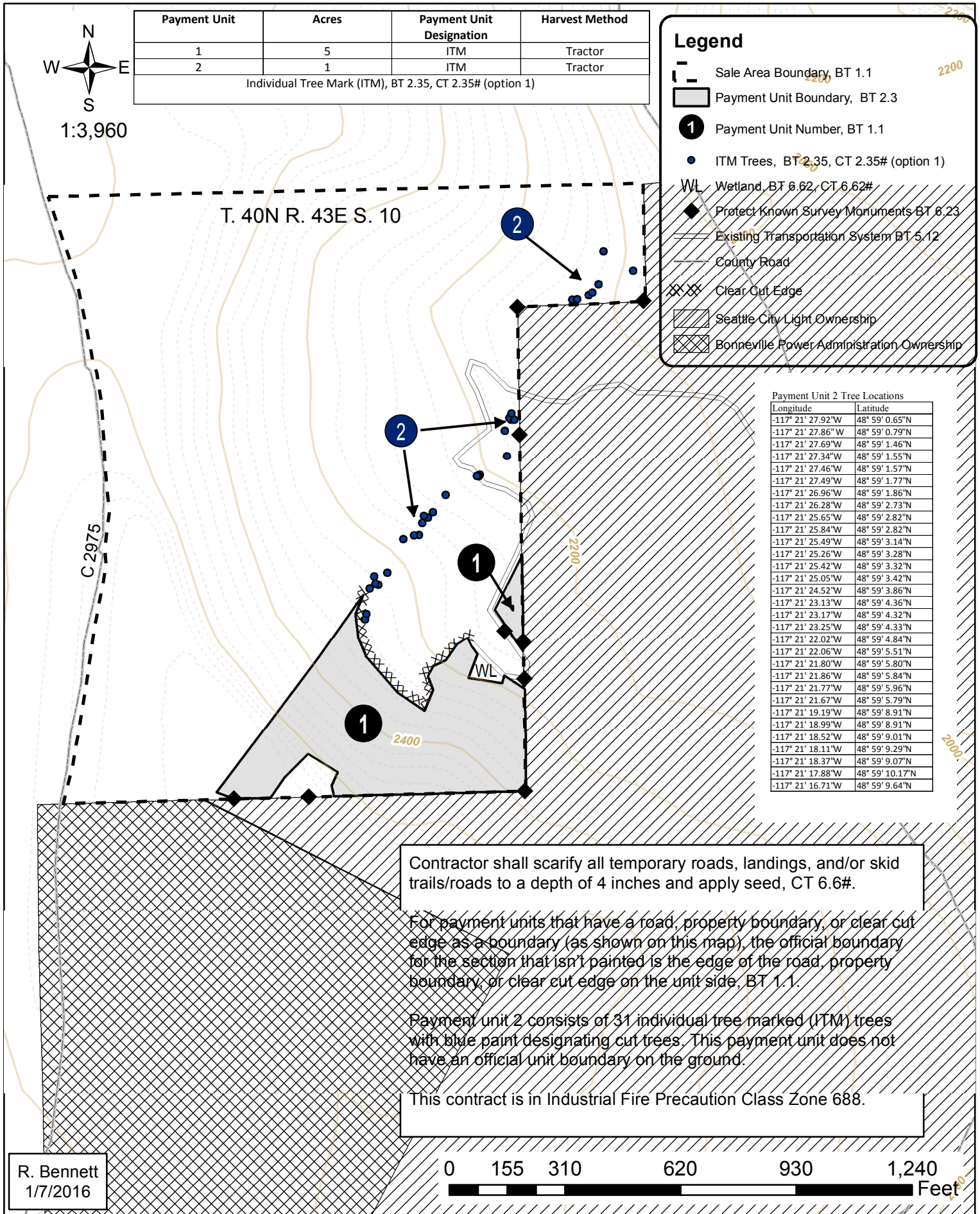

Payment Unit	Acres	Payment Unit Designation	Harvest Method
1	5	ITM	Tractor
2	1	ITM	Tractor
Individual Tree Mark (ITM), BT 2.35, CT 2.35# (option 1)			

Legend

- Sale Area Boundary, BT 1.1
- Payment Unit Boundary, BT 2.3
- Payment Unit Number, BT 1.1
- ITM Trees, BT 2.35, CT 2.35# (option 1)
- Wetland, BT 6.62, CT 6.62#
- Protect Known Survey Monuments BT 6.23
- Existing Transportation System BT 5.12
- County Road
- Clear Out Edge
- Seattle City Light Ownership
- Bonneville Power Administration Ownership

Payment Unit 2 Tree Locations

Longitude	Latitude
-117° 21' 27.92" W	48° 59' 0.65" N
-117° 21' 27.86" W	48° 59' 0.79" N
-117° 21' 27.69" W	48° 59' 1.46" N
-117° 21' 27.34" W	48° 59' 1.55" N
-117° 21' 27.46" W	48° 59' 1.57" N
-117° 21' 27.49" W	48° 59' 1.77" N
-117° 21' 26.96" W	48° 59' 1.86" N
-117° 21' 26.28" W	48° 59' 2.73" N
-117° 21' 25.65" W	48° 59' 2.82" N
-117° 21' 25.84" W	48° 59' 2.82" N
-117° 21' 25.49" W	48° 59' 3.14" N
-117° 21' 25.26" W	48° 59' 3.28" N
-117° 21' 25.42" W	48° 59' 3.32" N
-117° 21' 25.05" W	48° 59' 3.42" N
-117° 21' 24.52" W	48° 59' 3.86" N
-117° 21' 23.13" W	48° 59' 4.36" N
-117° 21' 23.17" W	48° 59' 4.32" N
-117° 21' 23.25" W	48° 59' 4.33" N
-117° 21' 22.02" W	48° 59' 4.84" N
-117° 21' 22.06" W	48° 59' 5.51" N
-117° 21' 21.80" W	48° 59' 5.80" N
-117° 21' 21.86" W	48° 59' 5.84" N
-117° 21' 21.77" W	48° 59' 5.96" N
-117° 21' 21.67" W	48° 59' 5.79" N
-117° 21' 19.19" W	48° 59' 8.91" N
-117° 21' 18.99" W	48° 59' 8.91" N
-117° 21' 18.52" W	48° 59' 9.01" N
-117° 21' 18.11" W	48° 59' 9.29" N
-117° 21' 18.37" W	48° 59' 9.07" N
-117° 21' 17.88" W	48° 59' 10.17" N
-117° 21' 16.71" W	48° 59' 9.64" N

Contractor shall scarify all temporary roads, landings, and/or skid trails/roads to a depth of 4 inches and apply seed, CT 6.6#.

For payment units that have a road, property boundary, or clear cut edge as a boundary (as shown on this map), the official boundary for the section that isn't painted is the edge of the road, property boundary, or clear cut edge on the unit side, BT 1.1.

Payment unit 2 consists of 31 individual tree marked (ITM) trees with blue paint designating cut trees. This payment unit does not have an official unit boundary on the ground.

This contract is in Industrial Fire Precaution Class Zone 688.

R. Bennett
1/7/2016

