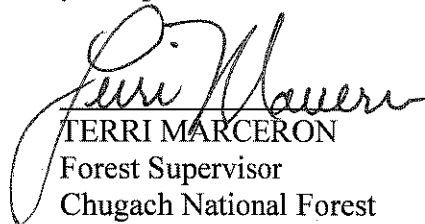

# Termination of an Order

## Chugach National Forest

Pursuant to Title 36 CFR 261.50(a) [and/or (b)], the prohibition(s) listed in Order Number 10-04-10-16-82, applicable to the Chugach National Forest, Girdwood Ranger District, dated April 8, 2016 and signed by Deyna Kuntzsch for Terri Marceron is (are) hereby terminated.

Executed in Anchorage, Alaska, this 22nd day of April 2016.

  
TERRI MARCERON  
Forest Supervisor  
Chugach National Forest

4/22/16  
Date

**CHUGACH NATIONAL FOREST**

Glacier Ranger District

Order No. 10-04-10-16-82

**EMERGENCY ORDER for SPECIAL CLOSURE**  
**Turnagain Pass Snowmachine Area Closure**

Pursuant to Title 36 Code of Federal Regulations 261.50 (a) and (b), the following restrictions are in effect on the Seward and Glacier Ranger Districts of the Chugach National Forest. These restrictions are in addition to those enumerated in Subpart A, Part 261, Title 36, Code of Federal Regulations, and become effective when signed and will remain in effect until April 30, 2016 unless rescinded earlier.

**Prohibited Acts:**

36 CFR261 .53 - Special Closures  
36 CFR 261.53 (f) – Property

Due to inadequate snow conditions and to prevent resource damage, operating or possessing a snowmachine in the Turnagain Pass area as described in Attachment A is prohibited.

**Exceptions:**

Pursuant to Title 36 CFR 261.50 (e) the following are exempt from this order:

1. Any person with a permit authorizing the otherwise prohibited act or omission.
2. Any Federal, State, or local officer, or member of any organized rescue or fire fighting force in the performance of an official duty.

These prohibitions are in addition to the general prohibitions in 36 CFR Part 261, Subpart A.

Executed in Anchorage, Alaska this 8<sup>th</sup> day of April, 2016.

*for Olypa Kuntz*  
TERKI MARCERON  
Forest Supervisor  
Chugach National Forest

*4/8/16*  
Date

**Penalty:**

Violations of these Prohibitions are punishable by a fine of not more than \$5,000 for per individual or \$10,000 for an organization, or imprisonment for not more than six months or both. [16 U.S.C. 551, and 18 U.S.C.3559 and 3571]

**Notification:**

A copy of this order shall be posted as prescribed under 36 CFR 261.51

# Winter Motor Vehicle Closure-Turnagain Pass

Order No. 10-04-10-16-82

Attachment A

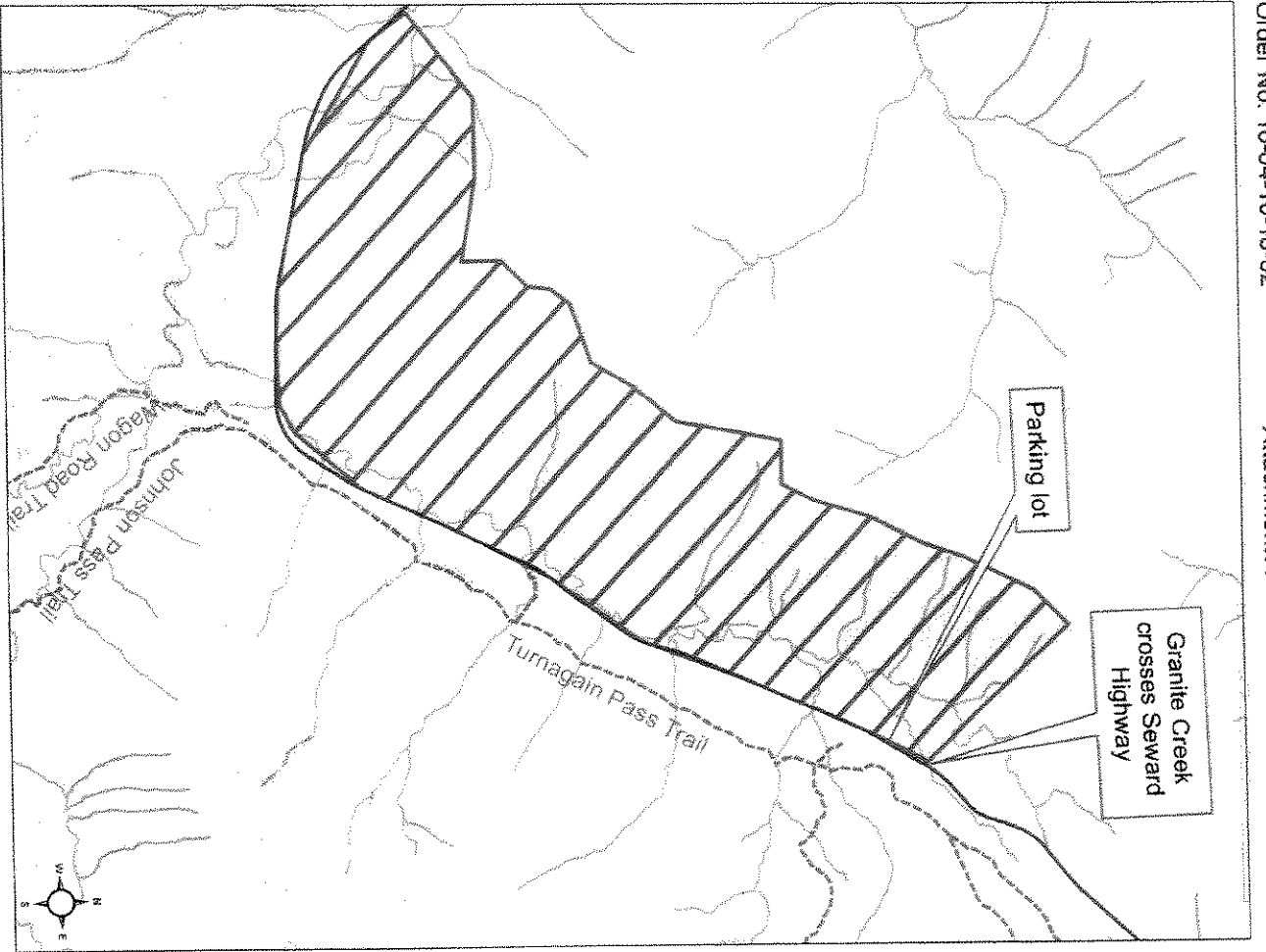

Map scale = 1:75,000

Locator Map

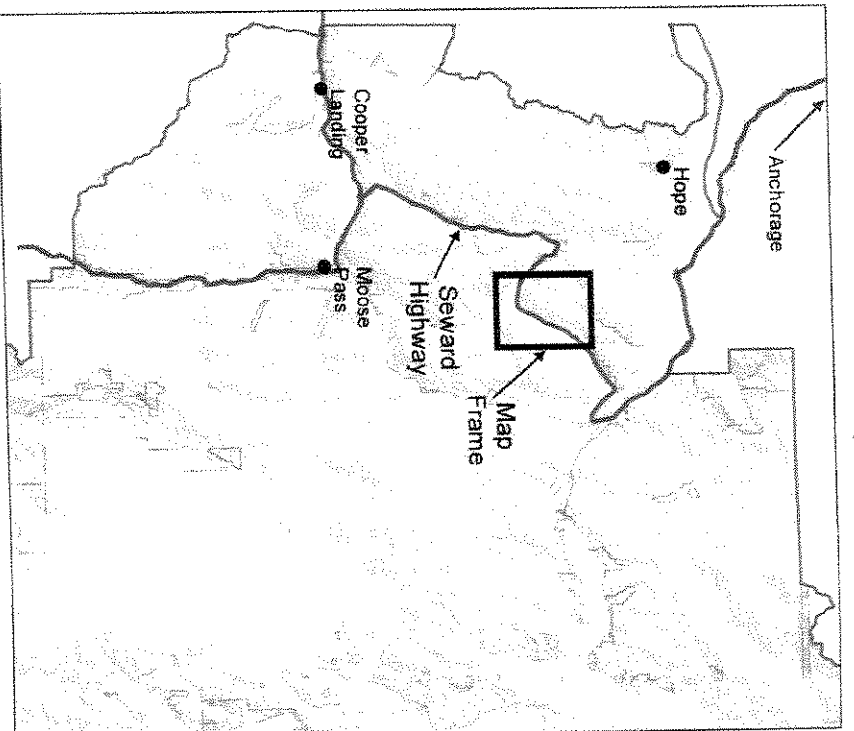

## Legend

- Highways
- Streams
- Emergency Closure Area
- Trail
- Other Ownership
- National Forest

All National Forest System land in the drainages of Virgin Creek, Kern Creek, Peterson Creek, and drainages of unnamed creeks on the north side of Blueberry Hill, as shown on the attached North Turnagain Arm map. The area is within or partially within Sections 1 thru 3, 11 thru 14, T9N, R2E; Sections 6, 7, T9N, R3E; Sections 14, 21 thru 29, 33 thru 36, T10N, R2E; Sections 19, 30, 31, T10N, R3E; SM.