

Curt Pond Timber Sale

Sale #: 16147 C-5053

Daniel Boone National Forest
 Stearns Ranger District
 Pulaski County, Kentucky



1:13,855

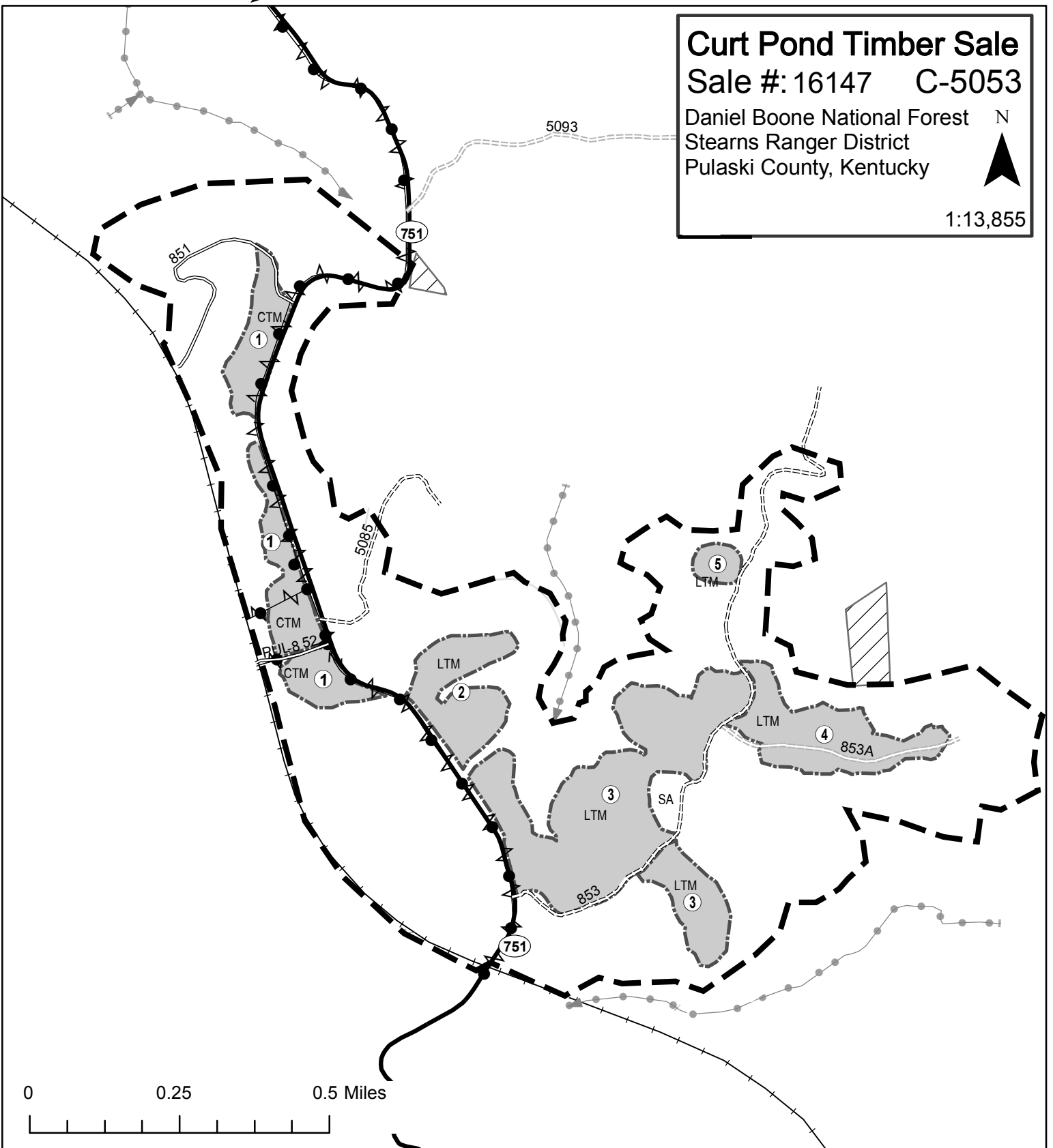

Legend

- | | | |
|-------------------------------|--|-----------------------------------|
| Payment Unit Boundary BT 1.1 | SA Protection of Special Areas CT 6.222# | Road Features |
| Sale Area Boundary BT 1.1 | Protection of Improvements Electric BT 6.221 | 1 - BASIC CUSTODIAL CARE (CLOSED) |
| Private Landownership | Protection of Improvements Water BT 6.221 | 2 - HIGH CLEARANCE VEHICLES |
| Payment Unit Number BT 1.1 | Stream Management Zone BT6.5 | 3 - SUITABLE FOR PASSENGER CARS |
| LTM Leave Tree Mark CT 2.355# | Railroad Active | 5 - HIGH DEGREE OF USER COMFORT |
| CTM Cut Tree Mark CT 2.355# | | |

Projected Coordinate System: NAD_1983_StatePlane_Kentucky_FIPS_1600_Feet