

ORDER

FOREST DEVELOPMENT ROADS

WALLOWA-WHITMAN NATIONAL FOREST

Pursuant to 36 CFR, Sec. 261.50(a) and (b), the following acts are prohibited on the roads and area described in this order within the Wallowa-Whitman National Forest, until further notice.

(1.) Using any type of vehicle prohibited by the order. For the purpose of this order, this restriction applies to motorized vehicles on the forest development roads and segments listed in Appendix A and shown on the map in Appendix B of this order (36 CFR 261.54(a)).

Pursuant to 36 CFR, Sec. 261.50(e), the following persons are exempt from this order:

- (1.) Persons with a permit specifically authorizing the prohibited act or omission.
- (2.) Any Federal, State or local officer, or member of an organized rescue or firefighting force in the performance of an official duty.

These prohibitions are in addition to the general prohibitions in 36 CFR Part 261, Subpart A.

Done at Baker City, Oregon, this 23rd day of October, 2001.



KARYN L. WOOD
Forest Supervisor
Wallowa-Whitman National Forest

Violation of these prohibitions is punishable by a fine of not more than \$5000 for an individual or \$10,000 for an organization, or imprisonment for not more than 6 months, or both. (16 U.S.C. 551 and 18 U.S.C. 3559 and 3571)

APPENDIX A

POLE CREEK AND SOUTH FORK CATHERINE CREEK ROAD CLOSURES

Those segments of the following Forest Development Roads in Township 5 South, Range 42 East, Sections 22, 26 and 27:

7700650	7700660
7700651	7700665
7700652	

Appendix B

- CLOSED ROADS**
- DISTRICT BOUNDARY
- N
- 2 Miles

T. 5 S.
R. 42 E.

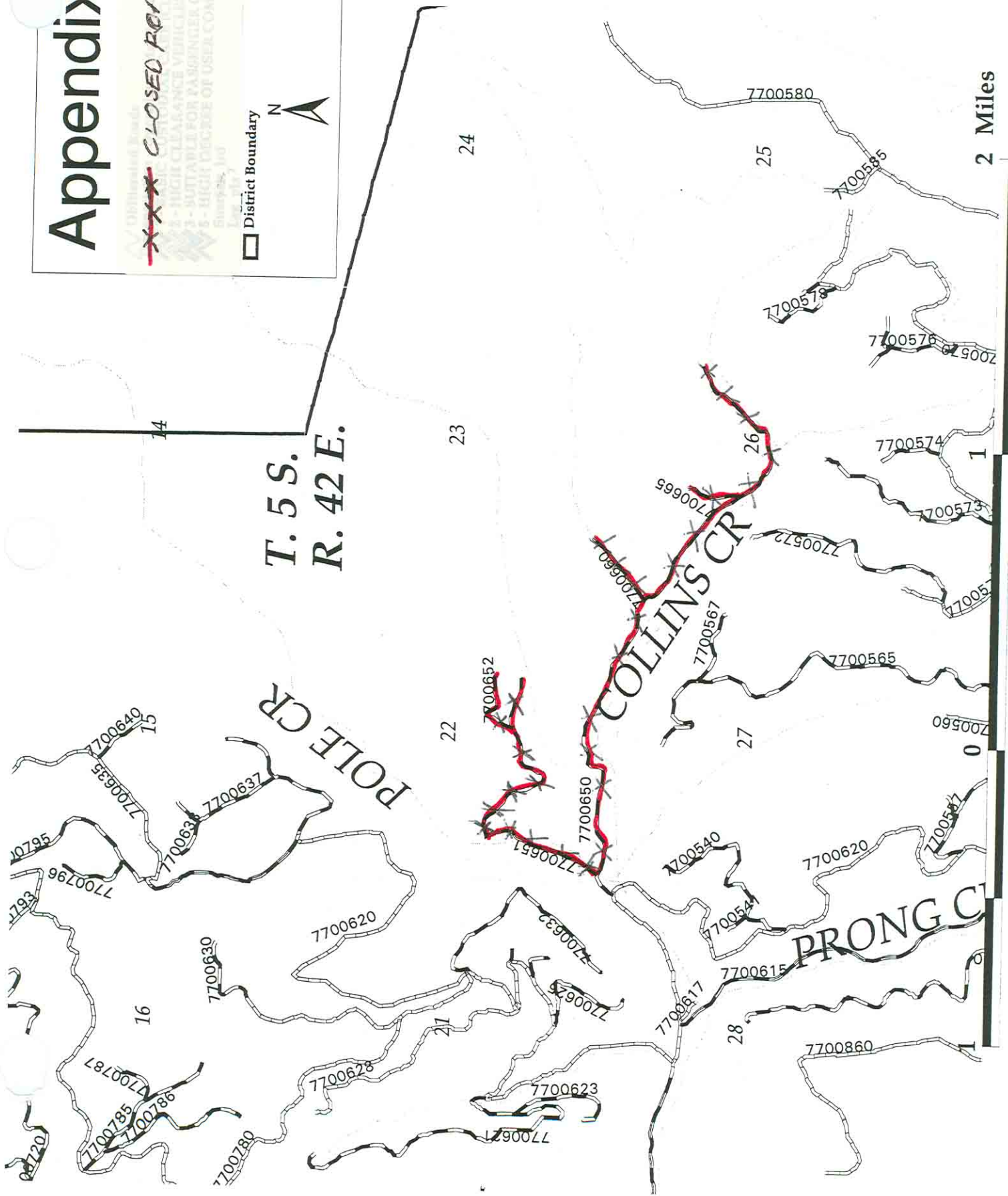

APPENDIX B

(map)

Assessment of Need and Enforcement Plan

1. During 1995 the road system up Pole Creek was decommissioned, as was the system in South Fork of Catherine Creek in 2001. Since this work was finished all terrain vehicles have begun to re-open these routes, which ultimately access the Eagle Cap Wilderness. We have received complaints from the public about this use and there was a considerable investment in this decommissioning work.

2. The intent of this order is to eliminate the motorized traffic-accessing wilderness, protect the decommissioning investment and reduce sediment to adjacent streams caused by continued disturbance by all terrain vehicles.

<u>Action</u>	<u>Responsible Person</u>	<u>Date</u>
Prepare Order	Will Novitske, L.E.O.	10-19-01
Review Order	Dwight Johnson, SLEO	10-22-01
Approve Order	Forest Supervisor	week of 10-23-01(proposed)
Posting	La Grande District personnel (According to 36 CFR 261.51)	10-23-01